

**NJ TRANSPORTATION**

# FAACBOOK 2003

New Jersey Department of Transportation

Governor James E. McGreevey

Commissioner Jack Lettiere



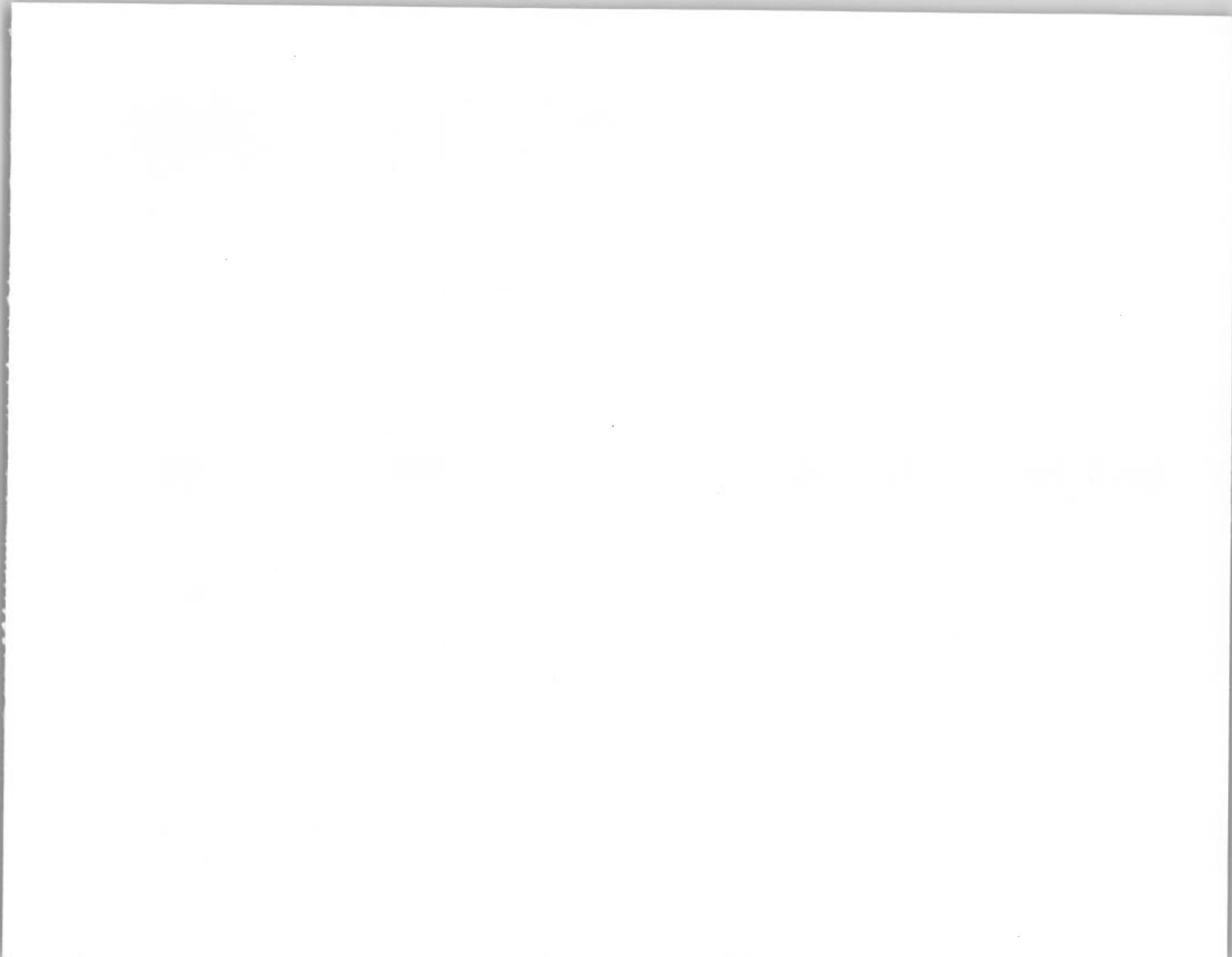

# NJ TRANSPORTATION

# FACTBOOK 2003

**New Jersey Department of Transportation**

**Governor James E. McGreevey**

**Commissioner Jack Lettiere**

The *New Jersey Transportation Fact Book 2003* presents information about the New Jersey Department of Transportation and other agencies that provide transportation services in New Jersey. We hope it will prove helpful. Please contact the NJDOT Communications Office at (609) 530-4280 for further information.



# Transportation in New Jersey



**James E. McGreevey**  
Governor



**Jack Lettiere**  
Commissioner

## Smart Transportation for Smart Growth

Targeted transportation capital investments are among the most effective means to achieve the goals of Governor James E. McGreevey's Smart Growth initiative. They will encourage Smart Growth development in urban and older suburban areas, protect open space, increase transportation options and reduce automobile traffic.

Closer operational and planning relationships between the various transportation agencies, starting with NJDOT and NJ TRANSIT and including the proposed consolidation of the New Jersey Turnpike and Garden State Parkway, lead the way to Smart Growth.

An efficient transportation system is a hallmark of our quality of life and economic productivity. The condition of our highways, the efficiency of our mass transit, our ability to make timely improvements and our strategic use of limited resources all support our Smart Growth goals.

The New Jersey Commissioner of Transportation serves *ex officio* for: New Jersey Transit Corporation, Chair; New Jersey Transportation Trust Fund Authority, Chair; Delaware Valley Regional Planning Commission; New Jersey Commerce and Economic Growth Commission, Board of Directors; New Jersey Highway Authority; New Jersey Monorail Legislative Commission; New Jersey Redevelopment Authority; New Jersey Turnpike Authority; North Jersey Transportation Planning Authority; Regional Intergovernmental Transportation Coordinating Study Commission; South Jersey Transportation Authority; South Jersey Transportation Planning Organization.



# Table of Contents

## New Jersey Department of Transportation

4

People  
Facilities  
Motor Vehicle Commission  
United States Department of Transportation

## Finance

8

Transportation Trust Fund  
Transportation Trust Fund for Counties and Municipalities  
Capital Budget

## Roads

15

NJ Highway Authority  
NJ Turnpike Authority  
Palisades Interstate Park Commission  
South Jersey Transportation Authority  
TRANSCOM

## Bridges and Tunnels

19

Bridge Owners  
Burlington County Bridge Commission  
Cape May County Bridge Commission  
Delaware River Joint Toll Bridge Commission  
Delaware River and Bay Authority  
Delaware River Port Authority

## Buses and Trains

22

NJ TRANSIT  
Board of Directors/Executive Staff  
Revenue  
Advisory Committees  
Ridership  
Bus Operations  
Rail Operations

## Aviation

24

Licensed Facilities  
Funding  
NJ Public Use Airports

## Goods Movement

29

Maritime Resources  
Portway  
Port Authority of New York and New Jersey

## Planning

33

Context Sensitive Design  
North Jersey Transportation Planning Authority  
Delaware Valley Regional Planning Commission  
South Jersey Transportation Planning Organization  
I-95 Corridor Coalition

## Research and Technology

35

## Transportation Demand Services

36

Commute Options  
Bicyclists  
Pedestrians  
Smart Moves for Business  
Transit Villages  
Transportation Management Associations  
WorkFirst New Jersey

# New Jersey Department of Transportation

## New Jersey Department of Transportation

1035 Parkway Avenue  
PO Box 600  
Trenton, NJ 08625

[www.njdot.nj.gov](http://www.njdot.nj.gov)  
[www.njcommuter.com](http://www.njcommuter.com)  
(609) 530-4280 (Communications)  
1(800) POTHOLE  
1(800) 245-POOL (Ridesharing)  
1(888) NJROADS (Customer Relations)

## Executive Management Team

Jack Lettiere	Commissioner
James Snyder	Deputy Commissioner
Kris Kolluri	Chief of Staff
Steven B. Hanson	Chief Financial Officer
Kathleen M. Immordino	Assistant Commissioner Administration
Arthur Silber	Assistant Commissioner Capital Program Management
Madelyn Rumowicz	Assistant Commissioner Interagency Coordination
Mark Matzen	Assistant Commissioner Intergovernmental Relations

Chester J. Lyszczyk

Assistant Commissioner  
Operations

W. Dennis Keck

Assistant Commissioner  
Planning and Development

Victoria Rivera-Cruz

Director  
Affirmative Action and  
Civil Rights

Richard Remington

Director  
Communications

Diane Legreide

Director  
Motor Vehicle Commission

Richard J. Gimello

Executive Director  
Maritime Resources

Robert Salman

Inspector General

## OUR MISSION

To provide reliable, environmentally and socially responsible transportation and motor vehicle services to support and improve the safety and mobility of people and goods in New Jersey.





## Employees

Over 5,162 men and women in NJDOT work in these job categories:

	Female	Male	Total
Technician	170	665	835
Skilled craft	10	673	683
Service maintenance	38	749	787
Professional	395	1063	1458
Paraprofessional	314	126	440
Officials & Administrators	60	199	259
Office clerical	587	113	700

## NJDOT Headquarters Facilities

David J. Goldberg Transportation Complex  
1035 Parkway Avenue  
PO Box 600  
Trenton 08625

Finance & Administration Building

Engineering & Operations Building

Arthur F. Foran Technical Services Building

Fernwood Shops: repair, dispatch, sign, pavement management, records and regional central electrical repairs

Central Warehouse

Materials Testing Laboratory

Office Supply Stockroom

Print Shop

DOT TOT

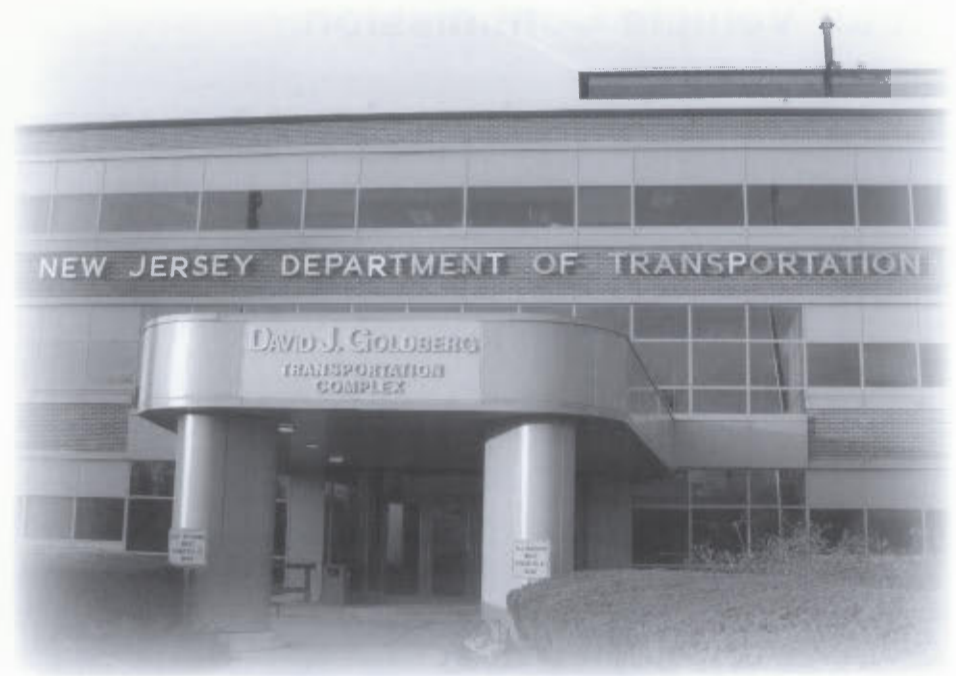

David J. Goldberg Transportation Complex

## Regional Headquarters

Region North  
200 Stierli Court  
Mount Arlington 07856-1322  
(973) 770-5170  
Aram Mardekian, Executive Director

Region Central  
100 Daniels Way  
Freehold 07728  
(732) 409-3263  
Bernard James, Executive Director

Region South  
One Executive Campus  
Route 70 West  
Cherry Hill 08002  
(856) 486-6600  
Jeffrey Callahan, Executive Director

## Motor Vehicle Commission

225 East State Street

Trenton 08666 [www.nj.gov/mvc](http://www.nj.gov/mvc)

[www.accessdmv.com](http://www.accessdmv.com) (Automated registration renewal)

1(888) 486-3339 (General information toll free in NJ) or

(609) 292-6500 (from out of state)

1(888) NJMOTOR (Inspection information)

1(877) DMVNJ4U (AccessDMV automated registration renewal)

1(888) 651-9999 (Insurance surcharge payments)



## Facilities

Individual facilities may contain one or more of the following:

Driver field testing	19
Driver written testing	31
Agencies	46
Inspection stations	32
Regional service centers	4

### Wayne Regional Service Center

1578 Route 23

Wayne 07470

### West Deptford Regional Service Center

Route 44 and Mid-Atlantic Parkway

West Deptford 08086

### Eatontown Regional Service Center

State Highway 36

Eatontown 07724

### Trenton Regional Service Center

120 South Stockton Street

Trenton 08666

Specialty sites	3
-----------------	---



# UNITED STATES DEPARTMENT OF TRANSPORTATION/NEW JERSEY

## Federal Highway Administration

840 Bear Tavern Road, Suite 310

West Trenton 08628-1019

[www.fhwa.dot.gov/](http://www.fhwa.dot.gov/)

(609) 637-4200; FAX (609) 538-4913

Washington Office: (202) 366-0650

Division Administrator

Dennis L. Merida

The Federal Highway Administration is part of the United States Department of Transportation with offices in each state. The New Jersey Division office is responsible for administering the federal aid program in New Jersey. Efforts are focused on five national strategic goals: mobility, safety, productivity, human and natural environment and national security.

Professionals provide technical expertise in these areas:

- roadway and bridge design, construction and maintenance
- value engineering and other evaluation tools
- policy and planning
- highway design and construction
- intelligent transportation systems
- environmental protection and enhancement
- innovative financing
- land acquisition
- research, development and technology transfer.

Employees

27 professionals

Program administered

\$750,000,000 a year

## Federal Motor Carrier Safety Administration

840 Bear Tavern Road, Suite 310

West Trenton 08628-1019

(609) 637-4222; FAX (609) 538-4913

### Field Office

275 Paterson Avenue

Little Falls 07424

(973) 357-4134; FAX (973) 357-4099

Division Administrator

Christopher Rotondo

Recent legislation established the Federal Motor Carrier Safety Administration within the United States Department of Transportation with offices in each state.

The primary goal of the Administration is to enforce federal safety and hazardous materials regulations and general highway safety programs. Through the Motor Carrier Safety Assistance Program and technology grants, the Administration provides funding to the states to enhance highway safety and enforcement.

Employees

13 professionals

Program administered

\$7,000,000 a year

# Finance

## New Jersey Transportation Trust Fund

Major funding is provided to transportation through the New Jersey Transportation Trust Fund which is up for renewal in FY 2004. Established in 1984, the fund uses revenues from a constitutionally dedicated state gas tax, the toll roads and certain heavy truck fees. Of the \$2.62 billion budget for NJDOT and NJ TRANSIT in FY 2003, the Trust Fund contributed \$408 million. The Trust Fund enables New Jersey to take advantage of all available federal and state monies for transportation.

### Capital Program

The FY 2003 Capital Program, a total of \$2.62 billion, is planned for state highway improvements, rail and bus improvements, local transportation needs, airports, intermodal goods movement enhancements, bicycle and pedestrian projects, transportation enhancements, and transportation and economic development projects.

The program is based on a New Jersey Transportation Trust Fund appropriation in fiscal year 2003 of \$408 million plus \$89,000,000 in additional funding made available by refinancing of the original Hudson-Bergen Light Rail Transportation Grant Anticipation Notes and \$965,000 for Air Safety.

Federal funds are assumed at a total level of \$1.33 billion, including \$821,667,000 from the Federal Highway Administration, \$484,870,000 from the Federal Transit Administration and \$21,000,000 from the Federal Aviation Administration.

This capital program is the product of extensive deliberations and outreach. The annual program — together with a draft multi-year plan — has been developed with the participation of New Jersey's three metropolitan planning organizations. These bodies, which are comprised largely of county and municipal representatives, are responsible for preparing and approving multi-year transportation improvements.

### Construction contracts awarded through NJDOT

Fiscal Year	Projects	\$ million
1996	131	\$595.4
1997	131	359.1
1998	135	410.9
1999	82	325.3
2000	101	440.6
2001	102	472.6
2002	96	472.5

### Consultant selections awarded through NJDOT

Fiscal Year	Projects	\$ million
1996	109	\$80.1
1997	62	38.9
1998	113	70.8
1999	95	55.4
2000	112	95.1
2001	101	114.7
2002	119	188.2





## Construction contracts awarded through NJ TRANSIT

Fiscal Year		\$ million
1996	50	\$140.7
1997	56	1,276.0
1998	45	99.2
1999	50	744.7
2000	41	148.9
2001	27	121.7
2002	30	90.6

## Consultant contracts awarded through NJ TRANSIT

Fiscal Year		\$ million
1996	54	\$59.4
1997	21	61.8
1998	33	15.0
1999	42	21.6
2000	19	20.4
2001	8	24.2
2002	18	25.9



# Transportation Trust Fund for Counties and Municipalities

## THE STATE AID PROGRAM

The State Aid Program, made up of three separate programs, distributes \$150,000,000 from the Transportation Trust Fund to counties and municipalities for deserving projects. All of the funding for these programs is subject to annual appropriation by the Legislature.

### County Aid: \$67,500,000

These funds are allotted to the 21 counties by a formula that takes into account the county's population and road mileage. Every year, each county develops an Annual Transportation Program (ATP) identifying projects and estimated costs. These may be improvements to public roads and bridges under county jurisdiction, public transportation or other transportation related work. Upon review and approval of the ATP, the Department provides up-front funding for the full amount of the county allotment.

### Discretionary Aid: \$15,000,000

These funds are set aside to address emergent or regional needs. Any county or municipality may apply at any time. These projects are approved at the discretion of the Commissioner of Transportation. NJDOT will pay 75 percent of the award amount or the allotment, whichever is less, at the time that the construction award is approved.

## Municipal Aid: \$67,500,000

All 566 municipalities may apply for projects that improve public roads and bridges under municipal jurisdiction. Applications are solicited, evaluated and rated by NJDOT staff. The results are presented to a Screening Committee comprised of Municipal Engineers and NJDOT staff appointed by the Commissioner of Transportation. The Committee evaluates the projects and makes recommendations to the Commissioner for approval. NJDOT will pay 75 percent of the award amount or the allotment; whichever is less, at the time that the construction award is approved. This is how these funds are distributed:

**\$59,979,000:** Appropriated for municipalities in each county based on a formula that takes into account county population and municipal road mileage within the county. These funds are allotted to individual projects within various municipalities through a competitive process.

**\$5,000,000:** Allotted to cities that qualify for urban aid under N.J.S.A.52:27D-178 et seq. "State Aid to Municipalities for Services and to Offset Property Taxes" as determined by the Division of Local Government Service, Department of Community Affairs. Funds are allotted based on a percentage of the amount of funds allocated to each eligible municipality by the Department of Community Affairs.

**\$2,521,000:** Allotted to Jersey City and Newark subject to review and approval of an ATP. This allocation is ensured at a level not less than their combined total of 1984 apportioned Federal Aid Urban System Funds and state match, including their portion of any non-attributable funds made available to Small Urban Areas.



## OTHER PROGRAMS

NJDOT distributes other monies to counties and municipalities for these projects:

### • Economic Development

In addition to our state and federal aid programs, NJDOT also supports the Governor's economic and business growth initiative and the state's redevelopment program. This is done through proactive business advocacy, Urban Coordinating Council technical support, Board representation on the NJ Commerce and Economic Growth Commission, the Brownfields Task Force technical support, and by reviewing existing legislation to provide flexible and proactive support to communities and their economic development plans.

### • Bicycle Projects, Local System

NJDOT has provided \$7 million to local governments to support projects that will result in the creation of a new independent bicycle facility or to make an existing roadway bicycle compatible.

### • Pedestrian Projects, Local System

To assist local governments in providing a safer environment for pedestrians, NJDOT has provided \$5 million for locally initiated pedestrian projects.

### • Local Aid for Centers of Place

Each year NJDOT provides funds to those communities that qualify as approved Centers of Place through the Department of Treasury's Office of State Planning. NJDOT has provided \$3 million for this program in fiscal year 2003.

## District 1

Roxbury Corporate Center  
200 Stierli Court  
Mount Arlington 07856  
(973) 770-5070  
FAX: (973) 770-5172

## District 4

1 Executive Campus  
Route 70 West  
Cherry Hill 08002  
(856) 486-6618  
FAX: (856) 486-6771

## District 2

153 Halsey Street, 5th Floor  
Newark 07102  
(973) 877-1500  
FAX: (973) 877-1556

## District 3

100 Daniels Way  
Freehold 07728  
(732) 308-4002  
FAX: (732) 308-4003

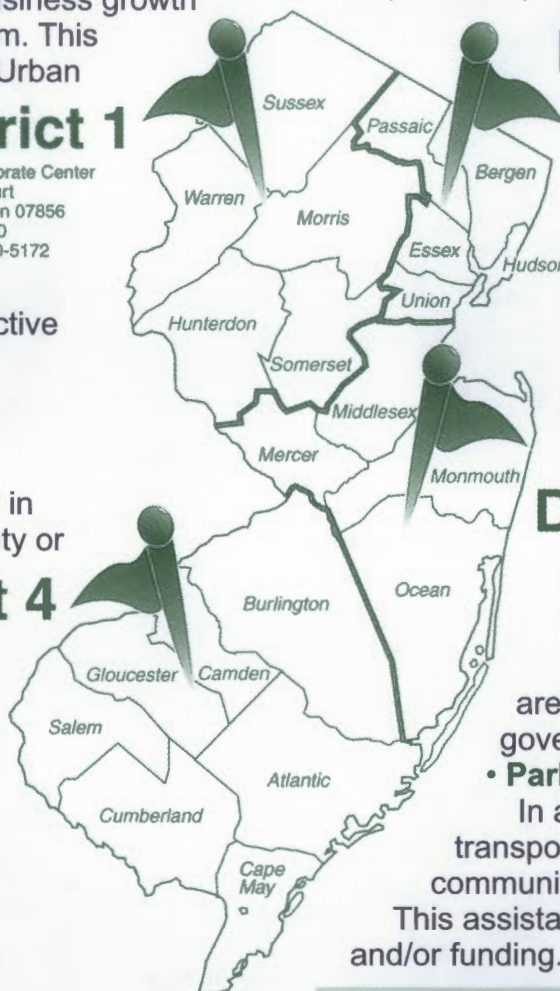

### • Livable Communities Pilot Program

New in 2003, Governor McGreevey approved the state budget with an appropriation of \$9 million for a Statewide Livable Communities Program. This program will fund planning, design and implementation of municipal projects to further investments in our transportation infrastructure and to support non-traditional transportation projects developed at the local level to advance

community based needs and goals.

### • Transportation Enhancement Program

Funds are provided from the Transportation Enhancement Act (TEA-21) and may be used for non-traditional transportation projects with a direct transportation relationship that enhance quality of life while reaching the greatest number of people.

### • Local Scoping and Local Lead Programs

These programs provide federal funds directly to counties and major cities for the advancement of projects through the National Environment Policy Act design, right-of-way, and/or construction. Projects are selected through the participation of the local governments in the Metropolitan Planning Process.

### • Park and Rides [www.njcommuter.com/html/prlocate.htm](http://www.njcommuter.com/html/prlocate.htm)

In an effort to promote alternate modes of transportation, NJDOT provides assistance to communities in identifying park and ride opportunities. This assistance may be in the form of technical assistance and/or funding.

More information is available online at  
[www.nj.gov/transportation/business/localaid](http://www.nj.gov/transportation/business/localaid)



# Capital Budget: \$2.618 billion

(in millions)

## Revenue Sources

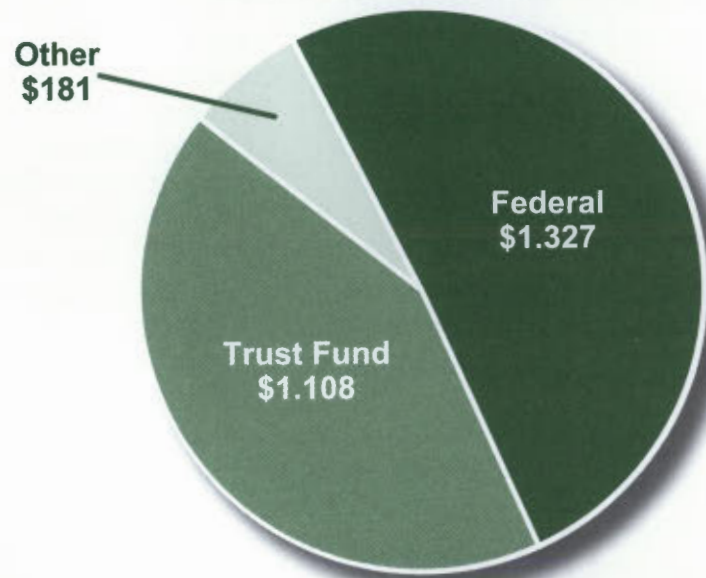

## Agencies

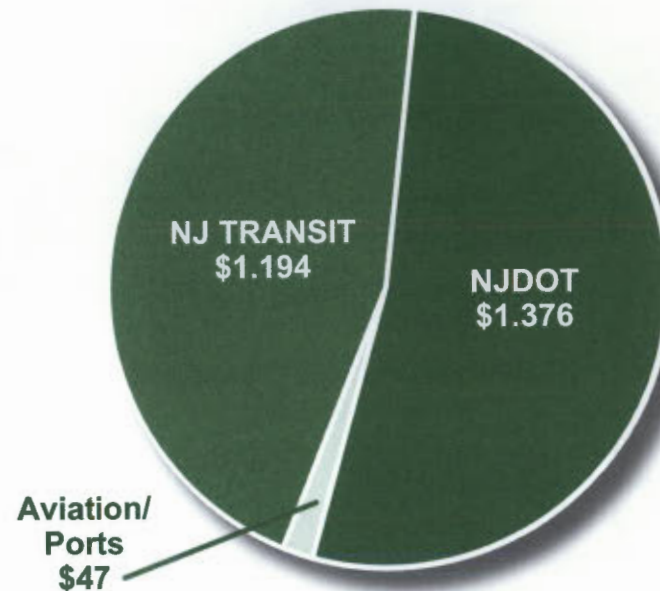

## Categories

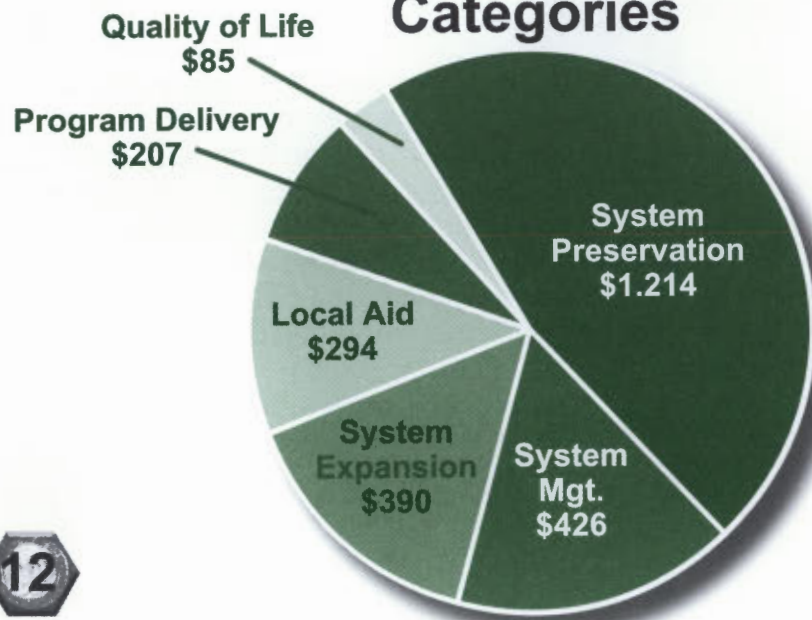

## Phase of Work

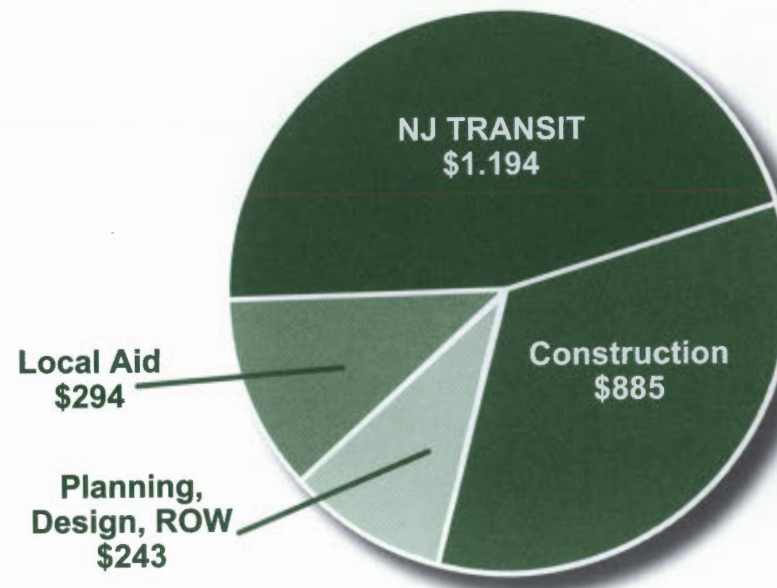



# Operating Budget: \$1.242 million

## Expenditures

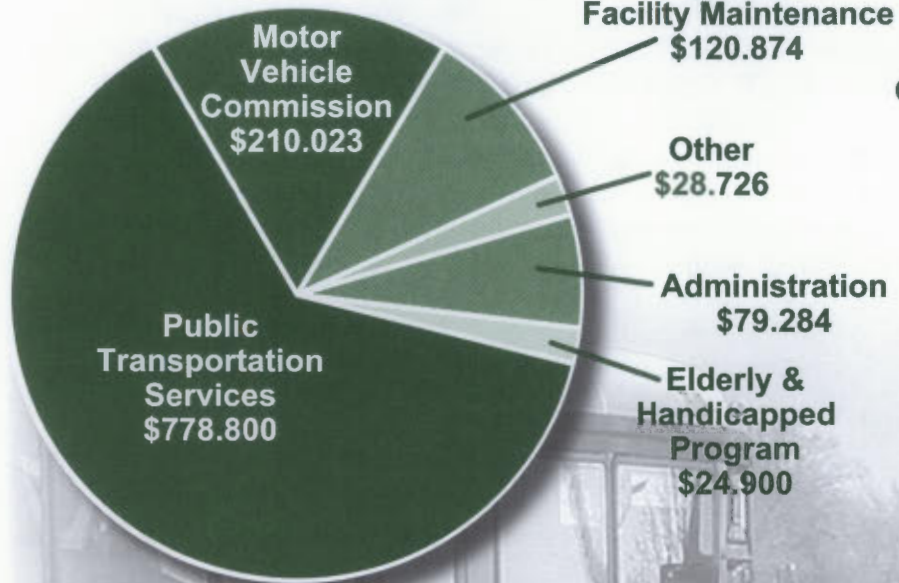

## Revenues

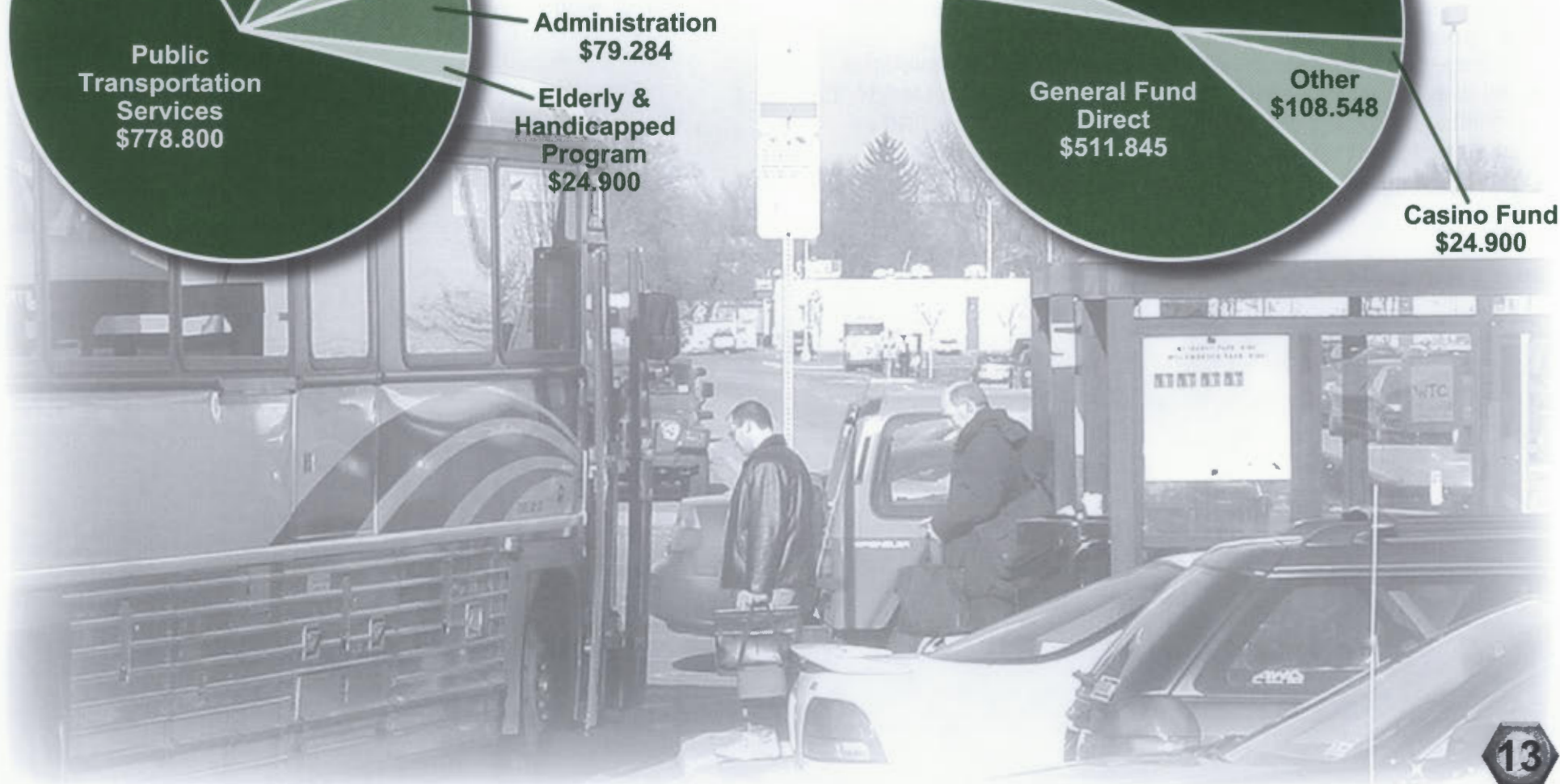
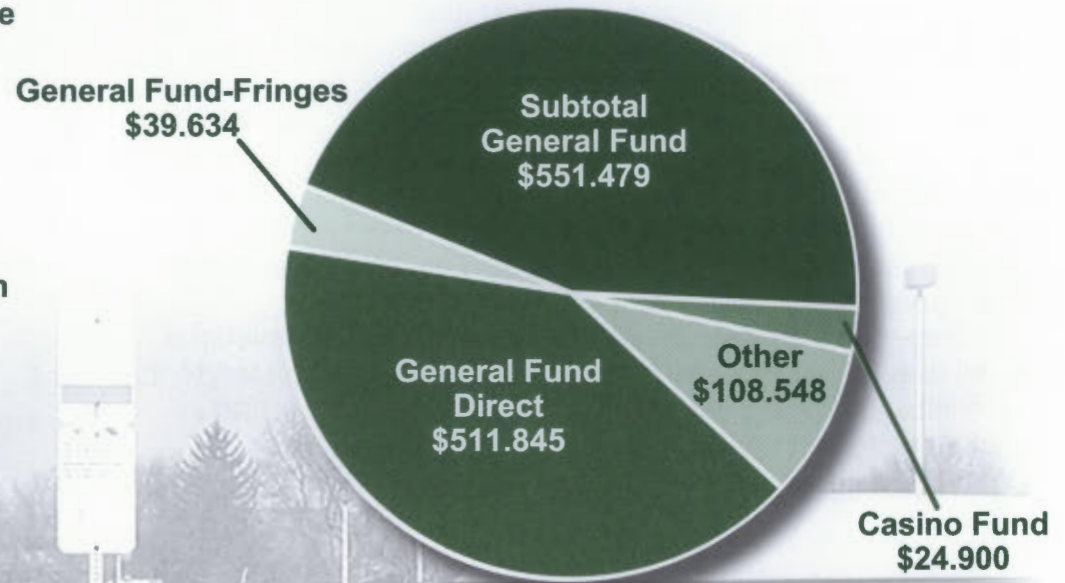

## TRUST FUND EXTENSION

The Legislature approved a four-year extension of New Jersey's Transportation Trust Fund (TTF) in 2000. The TTF provides money for highway and transit improvements throughout the state.

The Congestion Relief and Transportation Trust Fund Renewal Act, as the legislation is known, increased the size of the overall TTF program from \$700 million a year to \$900 million a year for the state fiscal year beginning July 1, 2000, and to \$950 million a year for the following three years. When combined with federal transportation funding, this will provide for an annual program of more than \$2 billion a year in transportation improvements for state highways, NJ TRANSIT, county and municipal needs and other transportation services.

In the legislation, lawmakers called on NJDOT to develop a capital investment strategy for the use of transportation funds, which lists goals such as reducing the backlog of structurally deficient bridges, improving highway pavement conditions, building new bikeways and reducing highway fatalities.



## Bridge Bond Update

All of the \$500 million of bridge bond funds for repair of county and municipal bridges and other statewide transportation projects have been appropriated.

A total of 231 local bridge projects received \$250 million. Of that amount \$19,363,712 has been expended to date. Of the \$80 million appropriated for public transportation (NJ TRANSIT) projects, \$72,870,804 has been expended. The NJ TRANSIT projects include the rehabilitation of the Bergen Tunnel, work at the Hoboken Terminal and Yard as well as the new Union Station on the Rahway Valley line. Of the \$170 million appropriated for statewide Department of Transportation projects, \$141,221,807 has been expended.



Green Sergeants Covered Bridge,  
Sergeantsville



# Roads

<b>Jurisdiction (2001)</b>	<b>Miles</b>
NJDOT	2,344*
NJ Turnpike Authority**	148
NJ Highway Authority**	173
South Jersey Transportation Authority	46
Palisades Interstate Parkway	11
Bridge Authorities	29
County	7,428
Municipality	25,382
Parks	649
<b>Total</b>	<b>36,210</b>
<b>Vehicle Miles Traveled (Annual)</b>	<b>Billions</b>
1990	58.922
1991	59.288
1992	59.249
1993	59.726
1994	60.466
1995	61.013
1996	62.164
1997	63.280
1998	64.616
1999	65.919
2000	67.172
2001	68.497

<b>NJDOT Operations</b>	<b>FY 2002 (est.)</b>
Contractor plows	1,147
Contractor loaders, graders	154
Contractor spreaders	134
Dams inspected annually	3
Dams owned	20
Drawbridges operated (2 or 3 shifts)	20
Drawbridge inspection (3 or 4 times annually)	228
Emergency service patrol responses	30,000
Emergency responses, after hours	7,000
Lane miles resurfaced	419
Lights maintained, highway	35,300
Lights maintained, lanes, ramps, shoulders	15,829
Mowings	33,000 acres
Mowings statewide	every 30 days
Permits, access	226
Permits, highway	2,775
Responses, emergency	20,000
Responses, after hours	15,829
Salt storage (in tons)	152,875

\*NJDOT operates and maintains 15,829 miles of lanes, ramps and outside shoulders.

\*\*Legislation to merge the New Jersey Turnpike and the Garden State Parkway was introduced in February 2003, less than a year after Governor James E. McGreevey established the Toll Road Consolidation Commission. Consolidation would provide \$42 million in savings over the next six years and further the Governor's goals of regional Smart Growth planning.





Traffic signals maintained	2
Traffic signals upgraded	140
Traffic signals relamped	2,094
Traffic signals inspected	5,614

#### Fleet

Autos	316
Trucks	1,691
Road equipment	5,821

#### Costs

Litter pickup	\$ 3,500,000
Snow / ice control	14,800,000
Striping	7,500,000
Trash removal	.9 million

## Safety First

A Highway Safety Task Force appointed by Governor James E. McGreevey unveiled a 12-point "Safety First" campaign in March.

The effort combines road improvements, stricter police enforcement and new driver education initiatives to reduce fatalities and injuries.

Task Force members represent NJDOT, the State Police, the AAA Auto Clubs of New Jersey, the New Jersey Motor Truck Association, the federal Motor Carrier Safety Administration and the Federal Highway Administration.

These are the initiatives:

#### Education

- New car-truck safety questions on driver test
- New focus on car-truck safety in Driver Education courses
- Mandatory safety training for CDL violators

#### Engineering

- \$15 million median barrier program
- 500 miles of raised pavement reflectors
- Greater visibility in construction areas
- \$5 million for new incident management technology

#### Enforcement

- Truck inspection at major NJ entry points
- Higher fines for overweight trucks
- Higher fines for faulty equipment
- Fines doubled in high accident corridors



## NEW JERSEY HIGHWAY AUTHORITY

Executive Offices

PO Box 5050

Woodbridge 07095

(732) 442-8600; FAX (732) 293-1200

[www.gspkwy.state.nj.us](http://www.gspkwy.state.nj.us)

Chairman  
Executive Director

Jerold L. Zaro  
Timothy C. McDonough

Facilities	Garden State Parkway PNC Bank Arts Center, Holmdel
------------	--

Annual Trips	\$408,836,000 (2001)
--------------	----------------------

Budget	\$219,350,000 (2002)
--------	----------------------

Employees	1,150
-----------	-------

## NEW JERSEY TURNPIKE AUTHORITY

Administration Building

PO Box 1121

New Brunswick 08903

(732) 247-0900; FAX (732) 937-5926

[www.state.nj.us/turnpike](http://www.state.nj.us/turnpike)

Chairman  
Vice Chairman  
Executive Director

Joseph Simunovich  
Joseph (J.P) Miele  
Michael J. Lapolla

Facilities: 28 interchanges, 8 maintenance districts and 12 service areas (Clara Barton, John Fenwick, Walt Whitman, James Fenimore Cooper, Richard Stockton, Woodrow Wilson, Molly Pitcher, Joyce Kilmer, Thomas Edison, Grover Cleveland, Alexander Hamilton, Vince Lombardi)

Annual trips	\$227,419,976 (2001)
Revenue	\$472,098,600
Number of Employees	1,494 full time; 485 part-time

## Blue Star Memorial Highway

The Blue Star Memorial Highway consists of sections of Routes 22, I-78, I-80, I-95, I-295 and I-287. This roadway was designated by the Legislature in 1948 as a "living memorial" to honor the men and women of New Jersey who served in the armed forces during World War II. The Blue Star Memorial Highway council was created shortly after to advise about the landscaping and roadside facilities. Members serve four-year terms and are unsalaried.



## PALISADES INTERSTATE PARK COMMISSION

PO Box 155

Alpine 07620

(201) 768-1360; FAX (201) 767-3842

Executive Director  
Superintendent

Carol Ash  
James Hall

Facilities	Palisades Interstate Parkway, two marinas, picnic areas, scenic roads and overlooks, historic sites and hiking trails
------------	--

Volume	27,000,000 vehicles 1,700,000 visitors
--------	---

Revenue	\$3,467,857
---------	-------------

Employees	90 (average full time/ New Jersey)
-----------	---------------------------------------

# **SOUTH JERSEY TRANSPORTATION AUTHORITY**

Farley Service Plaza  
PO Box 351  
Hammonton 08037  
(609) 965-6060; FAX (609) 965-7315  
[www.sjta.com](http://www.sjta.com)

Chairman  
Executive Director

Frank Spencer  
James A. Crawford

## **Facilities**

Atlantic City Expressway;  
Farley Service Plaza;  
Atlantic City International  
Airport; New York Avenue  
Parking Garage and Lot,  
Atlantic City

## **Volume**

1,000,000 passengers  
annually (Atlantic City  
International Airport)  
  
54,500,000 toll transactions  
Atlantic City Expressway (2001)

## **Revenue**

\$58,712,782

## **Employees**

261 full time; 109 part time;  
29 seasonal

# **TRANSCOM**

Transportation Operations Coordinating Committee  
Newport Financial Center  
111 Pavonia Avenue, 6th floor  
Jersey City 07310-1755  
(201) 963-4033; FAX (201) 963-8376  
[www.xcm.org](http://www.xcm.org)

TRANSCOM is a coalition of 18 highway, transit and public safety agencies in the New York-New Jersey-Connecticut metropolitan region. Created in 1986 to provide a cooperative approach to regional transportation management, it is funded by member agencies and the Federal Highway Administration.

The board is made up of the chief executives of the 18 member agencies and all actions require their unanimous approval.

## **Chairman**

Michael C. Ascher, P.E.,  
MTA Bridges and Tunnels  
Matthew Edelman

## **Executive Director**

## **Core programs**

Regional incident information  
and coordination  
(Operations Information Center)  
Regional Construction Coordination  
and Multi-agency Special Event  
Planning  
Multi-agency implementation of  
Intelligent Transportation Systems

## **Employees**

30



# Bridges & Tunnels

## HIGHWAY CARRYING BRIDGES

Bridge Owners	Bridges
Atlantic City Expressway	55
Beesley's Point Bridge Commission	2
Burlington County Bridge Commission	7
Cape May County Bridge Commission	5
Counties	2,431
Delaware and Raritan Canal	42
Delaware River and Bay Authority	2
Delaware River Joint Toll Bridge Commission	20
Delaware River Port Authority	4
Dingmans Ferry	1
Garden State Parkway	490
Margate Bridge	4
Municipalities	41
New Jersey Department of Transportation	2,346
New Jersey Sports and Expo Authority	2
New Jersey Turnpike Authority	504
NJ TRANSIT	108
Orphan	124
Palisades Interstate Parkway	15
Park Commission	1
Port Authority of NY & NJ	68
Private	18
State Parks	44
Federal	3
<b>TOTAL BRIDGES</b>	<b>6,337</b>

## TUNNELS

Route 29 Tunnel in Trenton opened February 2002;  
first tunnel owned and operated by NJDOT 1/2 mile

Atlantic City/Brigantine Connector opened June 2001;  
first tunnel owned and operated by South Jersey  
Transportation Authority 1/2 mile  
See also: Port Authority of New York and New Jersey, page 32

## BURLINGTON COUNTY BRIDGE COMMISSION

1300 Route 73 North  
PO Box 6  
Palmyra 08065-1090  
(856) 829-1900; FAX (856) 829-5205

Executive Director  
Chairman

J. Garfield DeMarco  
George N. Nyikita

Facilities	Volume
Tacony-Palmyra Bridge (toll)	16,329,153
Burlington-Bristol Bridge (toll)	7,860,158
Riverside-Delanco Bridge (non toll)	NA
Employees	116 full time; 47 part time

## CAPE MAY COUNTY BRIDGE COMMISSION

153 Crest Haven Road  
Cape May Court House 08210  
(609) 465-7806; FAX (609) 465-8405

Chairman	Gerard A. Desiderio
Executive Director	Stephen O'Connor
Vice Chairman	William Henfey
Treasurer	Salvatore J. DeSimone

## DELAWARE RIVER JOINT TOLL BRIDGE COMMISSION

Administration Building  
110 Wood Street  
Morrisville, PA 19067  
(215) 295-5061; FAX (215) 295-3337

Chairman	Harry Parkin
Executive Director	Frank G. McCartney

Toll Bridges	Trenton-Morrisville New Hope-Lambertville Interstate 78 Route 22 Easton-Phillipsburg Portland-Columbia Delaware Water Gap Milford-Montague
--------------	--

Facilities	Ocean City Longport Bridge Corsons Inlet Bridge Townsend's Inlet Bridge Grassy Sound Bridge Middle Thorofare Bridge
------------	---

Volume	4,985,229
Revenues	\$2,395,141
Employees	25 full time; 22 part time

Non-toll Bridges	Lower Trenton Calhoun Street I-95 Scudder Falls Washington Crossing New Hope-Lambertville Centre Bridge-Stockton Lumberville-Raven Rock Pedestrian Uhlertown-Frenchtown Upper Black Eddy-Milford Riegelsville Northampton Street Riverton-Belvidere Portland-Columbia Pedestrian
------------------	---

Volume	72,291,583 (toll) 56,510,816 (non-toll)
Revenues	\$31,890,188
Employees	340



# DELAWARE RIVER AND BAY AUTHORITY

PO Box 71  
New Castle, DE 19720  
(302) 571-6300; FAX (302) 571-6367  
[www.capemay-lewesferry.com](http://www.capemay-lewesferry.com)

Chairman  
Executive Director

Albert A. Fralinger, Jr.  
James T. Johnson, Jr., P.E.

## Facilities

Delaware Memorial Bridge  
Cape May-Lewes Ferry  
DRBA Business Centre  
Cape May Airport  
Millville Airport  
New Castle Airport  
Three Forts Ferry Crossing  
(35,000 passengers)  
Dover Civil Air Terminal @  
Dover Air Force Base

## Volume

Delaware Memorial Bridge  
16,400,000 (2001)  
Cape May-Lewes Ferry  
1,236,000 passengers (2001)  
408,000 vehicles (2001)

## Revenues

\$90,011,839 (2001)

## Employees

500

# DELAWARE RIVER PORT AUTHORITY

One Port Center  
2 Riverside Drive  
PO Box 1949  
Camden 08101  
(856) 968-2000; FAX (609) 968-2226  
[www.drpa.org](http://www.drpa.org)

Chairman

Manuel N. Stamatakis  
(PA)

Vice Chairman  
Chief Executive Officer

Jeffrey L. Nash (NJ)  
John Matheussen

## Facility

## Volume (westbound)

Betsy Ross Bridge 6,627,000

Commodore Barry Bridge 6,115,000

Walt Whitman Bridge 19,345,000

Ben Franklin Bridge 8,579,000

PATCO High Speed Line 3,500  
9 stations in Camden County,  
4 in Philadelphia passengers  
daily

## Parking

12,626 cars daily

## Employees

370 PATCO  
617 DRPA



# Buses & Trains

## NJ TRANSIT

One Penn Plaza East  
Newark 07105  
(973) 491-7000; FAX (973) 491-7567  
[njcustomersvc@njtransit.state.nj.us](mailto:njcustomersvc@njtransit.state.nj.us)  
[www.njtransit.com](http://www.njtransit.com)

New Jersey Transit owns and operates the state bus and train and light rail network. It also runs the Newark Subway and supports private bus operations.

### Board of Directors

Jack Lettiere  
Public members

Chairman  
Myron P. Shevell, Long Branch;  
John L. McGoldrick,  
Princeton; Patrick W. Parkinson,  
Middletown;  
Flora M. Castillo, Ventnor

*Ex officio*  
Robert Smartt

Paul Josephson  
Gwen A. Watson

State Treasurer's  
Representative  
Governor's Representative  
Board Secretary

### Executive Management Team

George D. Warrington

Executive Director

William R. Knapp

Vice President/General  
Manager, Rail Operations  
New Light Rail Construction  
Deputy Attorney General  
Auditor General  
Procurement and Support  
Services

Steve Santoro  
Rebecca Fields  
Robert J. Guarnieri  
Frank Hopper

Human Resources  
Assistant Executive Director  
Business Diversity  
Chief of Police  
Assistant Executive Director  
Policy, Technology & Customer  
Service  
Assistant Executive Director  
Capital Planning and Programs  
Corporate Communications and  
External Affairs  
Chief Financial Officer and  
Treasurer

Alma Scott-Buczak

Joseph Bober  
James Redeker

Richard Sarles

Lynn Bowersox

H. Charles Wedel

### Employees

**10,120**

Revenues	\$1,221,600,000
Fare box	546,900,000
Other (lease, parking, etc.)	65,600,000
State/federal reimbursements	609,100,000

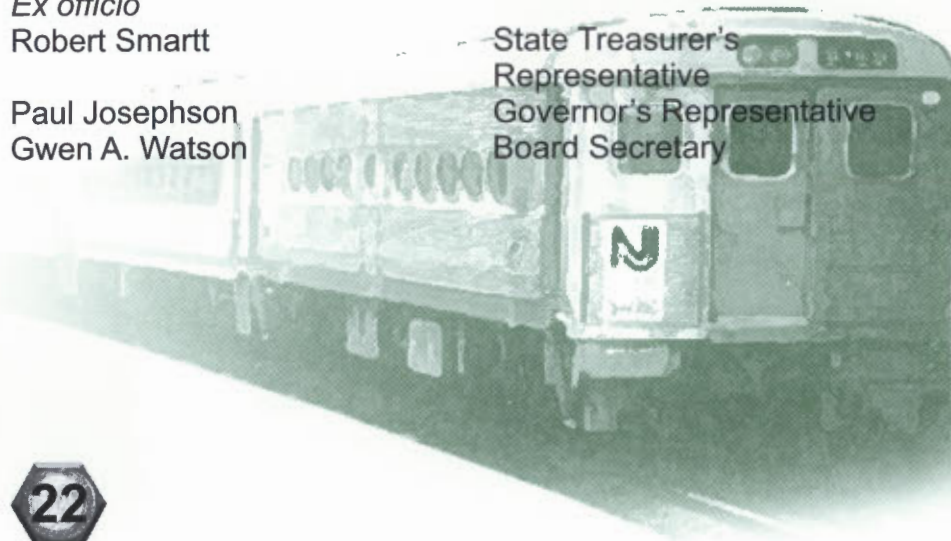



## Advisory Committees

### North Jersey Transit Advisory Committee

Suzanne Mack	Chairperson
Ronald Monaco	Vice Chairperson

### South Jersey Transit Advisory Committee

Anna Marie Gonnella	Chairperson
Ruth Byard	First Vice Chairperson
Jeffrey Marinoff	Second Vice Chairperson

### Business Transit Alliance

Michael Egenton	Chairperson
Joseph F. Luste, Jr.	Vice Chairperson

### Transit Plus Advisory Board

Nancy Schmatz	Chairperson
Paul Dreifuss	Vice Chairperson

### Private Carrier Advisory Committee

Gary Mariano	Co-Chairperson
Francis Tedesco	Co-Chairperson

### Local Programs Citizens Advisory Committee

Francis X. Herbert	Chairperson
Ann Burns	Vice Chairperson
Sigmund A. Kay	Second Vice Chairperson

### Ridership

	Daily	Annual
Bus	528,900	156,887,200
Rail	212,600	62,701,700
<b>Total passenger trips</b>	<b>752,600</b>	<b>222,600,000</b>
Bergen County Hudson-Bergen Light Rail	1,100	3,091,700

## Bus Operations

Routes	240
Annual route miles	84,600,000
Buses operated	2,025
Contract carriers	193
Buses leased (owned and leased)	778
Light Rail fleet (owned and leased)	45

<b>WHEELS</b>	<b>58</b>
---------------	-----------

## Newark Subway

Ridership	15,700 passenger trips
Subway cars	16
Bergen County Hudson-Bergen Light Rail Light Rail Ridership	3,091,700 passenger trips
Vehicles	27

## Rail Operations

Counties served	15
Passenger miles	1.36 billion
Route miles operated	975.2
Cars and locomotives	824
Rail stations	163

## Rail Lines

Atlantic City Line	North Jersey Coast Line
Bergen County Line	Northeast Corridor
Main & Bergen Line	Pascack Valley Line
Montclair-Boonton Line	Port Jervis Line
Morris & Essex Line	Raritan Valley Line

## Rail Safety

Operation Lifesaver participants and students educated in 2002:

35,000



# Aviation

## Licensed facilities 533

### Airports, public use 48

International 2

Publicly owned 15

Privately owned 29

State owned 1

Seaplane, privately owned 1

### Airports, restricted use 38

Publicly owned 2

Privately owned 33

Seaplane, privately owned 3

### Balloonports, public use 2

Privately owned 2

### Balloonports, restricted use 10

Publicly owned 1

Privately owned 9

### Heliports, public use 4

Publicly owned 2

Privately owned 2

### Helistops, restricted use 363

Publicly owned 60

Privately owned 266

Hospitals 37

### Special use 42

Landing strips, private 42

### Licensed Operations 26

Agricultural 14

Aerial advertising 10

Sport parachute centers 2

Atlantic City International Airport, **See Page 25**

Newark Liberty International Airport, **See Page 26**

## Funding

Fiscal Year	Transportation Trust Fund obligated
1997	\$4,973,489.82
1998	3,605,995.03
1999	657,669.00
2000	4,566,876.00
2001	6,882,000.00
2002	6,356,000.00

Fiscal Year	Federal block grant funds obligated
1997	\$3,330,478.46
1998	4,966,220.00
1999	15,815,307.00
2000	6,709,900.00
2001	2,635,400.00
2002	\$0



<b>Fiscal Year</b>	<b>Airport safety funds (aviation fuels tax revenue)</b>
1997	\$596,444.48
1998	357,626.75
1999	83,495.61
2000	154,188.00
2001	96,963.00
2002	119,398.00

## New Jersey Public Use Airports

**Aeroflex-Andover Field**  
John T. Flynte  
Limecrest Road  
Andover  
(973) 786-5100

**Alexandria Field**  
William Fritsche  
Airport Road  
Pittstown  
(908) 730-9223

**Atlantic City International Airport**  
Thomas Rafter, A.A.E  
Tilton & Pomona Roads  
Atlantic City  
(609) 645-7895

**Bader Field Airport**  
Jerry Kilby  
Pleasantville Boulevard  
Atlantic City  
(609) 347-5360

**Blairstown Airport**  
Doug Ferry  
Lambert Road  
Blairstown  
(908) 362-9170

**Bucks Airport**  
Joseph J. DiOrio  
Routes 77 and 49  
Bridgeton  
(856) 455-3990

**Camden County Airport**  
Karl M. Kleinberg  
New Freedom Road  
Berlin  
(856) 767-1233

**Cape May County Airport**  
Tom Berry  
County Route 613  
Rio Grande  
(609) 886-8652  
(operated by DRBA)

**Central Jersey Regional Airport**  
Joseph Horner  
Millstone River Road  
Somerville  
(908) 526-2822

**Cross Keys Airport**  
Henry Ostrowsky  
North Tuckahoe Road  
Williamstown  
(856) 629-3033

**Eagles Nest Airport**  
Diane Kummings  
Stafford-Forge Road  
West Creek  
(609) 641-5822

**Essex County Airport**  
Thomas Gomez  
Wright Way  
Fairfield  
(973) 227-4567

**Flying W Airport**  
John Cove  
Fostertown Road  
Medford  
(609) 267-7673

**Greenwood Lake Airport**  
NJDOT  
Airport Road  
West Milford  
(609) 530-2900

**Hackettstown Airport**  
Donald Schwanda  
Airport Road  
Hackettstown  
(908) 852-4664

**Hammonton Municipal Airport**

Andrew Kondrach

County Route 693

Hammonton  
(609) 561-0100**Kroelinger Airport**

Alfred J. Bernardini

Rt. 47

Vineland  
(856) 696-5481**Lakewood Airport**

Frank Edwards

Route 528

Lakewood  
(732) 364-0800**LiCalzi Airpark**

Gertrude J. LiCalzi

Dutch Neck Road

Bridgeton  
(856) 451-2186**Lincoln Park Airport**

Joseph Rendeiro

Beaver Brook Road

Lincoln Park  
(973) 628-7166**Linden Airport**

Paul Dudley

Route 1

Linden  
(908) 862-5557**Little Ferry Seaplane Base**

Anastasios Georgas

Bergen Turnpike & Main  
StreetLittle Ferry  
(201) 440-1100**Millville Airport**

Rocco Tomanelli

Cedarsville Road

Millville  
(856) 825-1244  
(operated by DRBA)**Monmouth Executive Airport**

Ed Brown

Highway 34

Wall  
(732) 938-4800**Morristown Municipal Airport**

William G. Barkhauer

Airport Road

Morristown  
(973) 538-6400**Newark Liberty International Airport**

Susan Baer

Route 22 &amp; NJ Turnpike

Newark  
(973) 961-6000**Newton Airport**

Stella Jump

Stickles Pond Road

Newton  
(973) 383-3549**Ocean City Municipal Airport**

William R. Colangelo

26<sup>th</sup> and Bay AvenueOcean City  
(609) 525-9223**Old Bridge Airport**

Paul Cerniglia

Pension Road

Old Bridge  
(732) 446-0303**Princeton Airport**

Ken A. Nierenberg

Route 206

Princeton  
(609) 921-3100**Red Lion Airport**

Marianne B. Worth

Red Lion Road

Southampton  
(609) 859-2266**Red Wing Airport**

George P. Dengler

Jobstown-

Juliustown Road

Jobstown  
(609) 298-6645**Robert J. Miller Airpark**

Stephen Childers

Route 530

Berkeley Township  
(732) 240-3520



**Rudy's Airport**  
Rudolph Chalow

Stanley Terrace  
Vineland  
(856) 691-4917

**Trenton-Robbinsville Airport**  
Mark Sentarian

Sharon Road  
Robbinsville  
(609) 259-1059

**Sky Manor Airport**  
Kent Linn

Sky Manor Road  
Pittstown  
(908) 996-4200

**Trinca Airport**  
Alexander Davidson

Airport Road  
Andover  
(973) 786-5019

**Solberg-Hunterdon Airport**  
Solberg Aviation Company

Thor Solberg Road  
Readington  
(908) 534-4000

**Twin Pine Airport**  
William Weasner

Pennington-Lawrenceville  
Road & Federal City Road  
Pennington  
(609) 737-0001

**Somerset Airport**  
G. Daniel Walker

Airport Road  
Bedminster  
(908) 722-2444

**Vineland-Downstown Airport**  
Curtis Nixholm

Harding Highway  
Vineland  
(856) 697-3300

**South Jersey Regional Airport**  
Robert Matthews

Stacy Haines Road  
Medford  
(609) 267-3131

**Woodbine Municipal Airport**  
Clifton Anderson

County Route 550  
Woodbine  
(609) 861-1300

**Southern Cross Airport**  
Edward A. Carter

South Tuckahoe Road  
Williamstown  
(856) 629-6699

**Spitfire Aerodome**  
Jack Fetsko

Route 643  
Pedricktown  
(856) 351-9300

**Sussex Airport**  
Paul G. Styger

Route 565  
Sussex  
(973) 875-7337

**Teterboro Airport**  
Lanny Rider

Industrial Avenue  
Teterboro  
(201) 296-4737

**Trenton-Mercer Airport**  
Justin Edwards

Bear Tavern Road  
West Trenton  
(609) 882-1601



# New Jersey Public Use Airports





# Goods Movement

<b>Total freight tonnage:</b>	<b>375.2 million tons</b>
Truck	283.1 million tons
Rail	66.5 million tons
Water	24.4 million tons
Air	1.2 million tons

## **Port Newark/Elizabeth (2001)**

19.8 million metric tons (1.95 million ocean containers)

229,000 direct/indirect jobs \$25 billion business

## **South Jersey Port Corporation (2001)**

2.35 million tons

24,605 direct/indirect jobs \$398 million business

## **Newark Liberty International Airport (2001)**

787,00 tons (2.3 million tons regional\*)  
8th largest air cargo in US (20th in world)

\* including FedEx and UPS

## **Distribution**

Centrally located in the largest market in the world  
Within one day of 2/3 of US population  
NJ's fourth largest industry

## **Maritime Resources**

The Office of Maritime Resources (OMR) provides interagency support, program planning and policy recommendations on maritime issues to the Governor, Commissioner and the Legislature. It also promotes coordination and cooperation with and among state, multi-state, federal and non-governmental agencies and provides public education on maritime issues.

OMR serves as the primary advisory body and lead agency for support of New Jersey's \$50 billion maritime industry which includes ports and terminals, cargo movement, boat manufacturing and sales, ferry operations, government services, marine trades and maritime environmental resources.

The office supports technology research and development, investigates innovative dredged material management technologies to ensure a balance between development and protection of the ecosystem, and advocates and plans for continued development and growth of New Jersey's marine transportation system.

## **OMR projects include:**

**Policy and Planning:** The Comprehensive Port Improvement Plan, Port Jersey Channel Deepening, NJDOT Berm Project, National Marine Transportation System Initiative, NJ's Marine Trades Program, federal initiatives such as the Water Resources Development Act, ISTEPA, Harbor Maintenance Tax and the Claremont Channel, the Volatilization Project (PCBs from dredged materials), Coast Day, "All Hands On Deck" Harbor Education Program, NJDOT Freight Working Group, State Channel Dredging, Dredged Material Management, marine trade industry surveys, Commuter Ferry Wake Study.



**Maritime Development:** Commuter ferries, Port Inland Distribution Network and related short sea shipping efforts, National Boating Infrastructure Grant Program, Maritime Industry Fund, federal initiatives, Delaware River Ports, Military Ocean Terminal Bayonne and harbor deepening.

**Marine Biology:** NJ Toxics Workplan, Harbor Estuary Program, NJ Flats, Passaic River Restoration, Hudson-Raritan Restoration Program.

**Technology Development:** AirGuard™ (pneumatic sediment barrier system), Palmyra Cove Demonstration Project, Decontamination Technologies Demonstration Program, PA Mines Demonstration Project, NJ Sediment Processing Facility, Dredged Material Beneficial Use Options.

Director of Maritime Resources (609) 530-4770

#### **Commercial Vehicles Information Systems and Networks**

New Jersey began to design a Commercial Vehicle Information Systems and Networks (CVISN) program in 2000. The objective is to have an electronic data exchange to support commercial vehicle operations. The system will be consistent with the state's commitments, federal standards and compatible with systems in other states.

New Jersey's CVISN is being developed by a project team that includes public agencies, regional authorities and organizations, the Federal Motor Carrier Safety Administration and the Federal Highway Administration. Its first action was to design timely access to safety and health assurance information about drivers, vehicles and carriers on inspections and accidents, end-to-end electronic credentialing and electronic data exchanges for automated, accurate roadside and fixed-site screening.

A CVISN in New Jersey will result in a more efficient flow of commerce, access to accurate information by law enforcement and a greater level of safety and health protection for residents.

#### **The Intermodal International Transportation Center**

The Intermodal International Transportation Center is a university-based resource center for advanced intermodal transportation research and economic planning at the New Jersey Institute of Technology. The center supports the development and maintenance of a safe, efficient, integrated regional multimodal transportation system serving the communities and residents of northern New Jersey and beyond.

#### **Portway International Intermodal Corridor**

Portway is a series of 11 independent NJDOT projects that will improve access to and between the Newark-Elizabeth Air/Seaport Complex, intermodal rail facilities, trucking and warehousing/transfer facilities, and the regional surface transportation system. These facilities and their access routes are the front door to global and domestic commerce for New Jersey and the greater metropolitan New York region.

##### **The Goals of Portway**

- Portway will increase safety and support seamless intermodal and roadway connections.
- Portway will relieve current high levels of congestion and meet growing future demands resulting from increased activity at port facilities, rail yards and distribution centers.
- Portway will promote economic development, create jobs, and improve the environment.
- Portway will improve access to Brownfields sites and facilitate their re-use as value-added processing centers and other goods movement logistics purposes.

Director of Division of Systems Planning & Research  
(609) 530-2866



**PORTWAY INTERNATIONAL / INTERMODAL CORRIDOR**

**STATE OF NEW JERSEY**

**PORTWAY INTERNATIONAL / INTERMODAL CORRIDOR**

COMPUTER GENERATED BY THE  
NEW JERSEY DEPARTMENT OF TRANSPORTATION  
DIVISION OF INFORMATION TECHNOLOGY

GEODATAPAC INFORMATION SYSTEMS  
IN COOPERATION WITH  
U.S. DEPARTMENT OF TRANSPORTATION  
FEDERAL HIGHWAY ADMINISTRATION

**LEGEND**

- CSAO
- NY & W
- PORTWAY
- RAIL YARD
- PORT FACILITIES
- HUDSON-BERGEN LIGHT RAIL (PROPOSED)
- CEIL
- NORTHEAST CORRIDOR
- NORFOLK SOUTHERN
- PORTWAY EXTENSIONS

TABLE 1. *Continued*

# PORT AUTHORITY OF NEW YORK AND NEW JERSEY

225 Park Avenue South, 18<sup>th</sup> Floor  
New York, NY 10003  
(212) 435-7000  
(973) 961-6600  
[www.panynj.gov](http://www.panynj.gov)

Executive Director  
Chairman

Joseph J. Seymour  
Jack G. Sinagra

## Facility

### Aviation

John F. Kennedy International Airport  
Newark Liberty International Airport  
LaGuardia Airport  
Teterboro Airport  
Downtown Manhattan Heliport  
AirTrain Newark  
AirTrain JFK

### Port Commerce

Port Newark  
Elizabeth-Port Authority Marine  
Terminal  
Port Authority Auto Marine Terminal  
Brooklyn Piers  
Red Hook Container Terminal  
Howland Hook Marine Terminal

### PATH

PATH Rail Rapid Transit System  
Journal Square Transportation Center  
Harrison Car Maintenance Facility  
Consolidated Maintenance Facility  
Running Repair Shop  
13 PATH Stations

## Facility

## Volume

Port Authority Bus Terminal

57,000,000 passengers  
2,200,000 bus  
movements (2001)

George Washington Bridge (G.W.B.)

53,467,000 vehicles  
(2001)

G.W.B. Bus Station

5,500,000 passengers,  
262,000 bus  
movements (2001)

Lincoln Tunnel

20,987,000 vehicles  
(2001 eastbound)

Holland Tunnel

4,616,000 vehicles  
(2001 eastbound)

Staten Island Bridges

Goethals Bridge

14,236,000 vehicles  
(2001 eastbound)

Bayonne Bridge

3,556,000 vehicles  
(2001 eastbound)

Outerbridge Crossing

15,020,000 vehicles  
(2001 eastbound)

Employees

6,075 PANY/NJ  
980 PATH  
7,055





# Planning

The Department's planning is done in several formats. One is a long range look at strategic transportation issues through 2025. We also have short-term agendas. One example is a plan to reduce the backlog of deteriorating bridges through several funding plans. Feasibility and scoping for construction projects already in the pipeline are also planning tasks.

The NJDOT planning process is collaborative: the desires of the people who live, work or pass through transportation projects are central to it. Our priorities are not only safety and mobility but also societal, aesthetic, historic and environmental values. Continued dialogue with our constituents is central to our Context Sensitive Design techniques.

An update of the state's long range plan, *Transportation Choices 2025*, identifies and addresses the needs and priorities of New Jersey's transportation system over the next 25 years. It establishes a policy structure to support the changing system and sets out the strategies and financial resources needed to sustain this vision.

The plan contains five-year and 10-year programs and a 25-year forecast; technical analyses of core issues and the results of extensive public outreach through focus groups, surveys, interviews with public agencies and interest groups, information centers, employee reactions and an interactive web site. Copies of the plan are available from James Lewis at (609) 530-2884. The plan is also available online, [www.njchoices.com](http://www.njchoices.com).

Metropolitan Planning Organizations (MPOs) composed of locally elected officials and representatives of transportation and other state agencies are federally mandated and designated by the Governor in each urban area. Each is a forum for continuing coordinated transportation planning and programs for its portion of the federal funds in a document called a Transportation Improvement Program (TIP). The MPOs formulate a long-range transportation plan, set short-term priorities, allocate funds and involve the public.

NJDOT is a voting member of each of the state's three regional MPOs and coordinates their TIPs. Following MPO approval of the TIP, the Department assembles them into a statewide TIP, which is submitted to the Federal Highway Administration and the Federal Transit Administration.

*Transportation Choices 2025* provides direction for the MPOs to conduct the corridor studies and complete other preparatory work for identifying regional projects. MPO plans and *Transportation Choices 2025* support New Jersey's *State Development and Redevelopment Plan*, a guide to direct investment and growth that can be sustained in areas in New Jersey where a transportation infrastructure already exists. This approach also protects rural and sensitive lands from development.

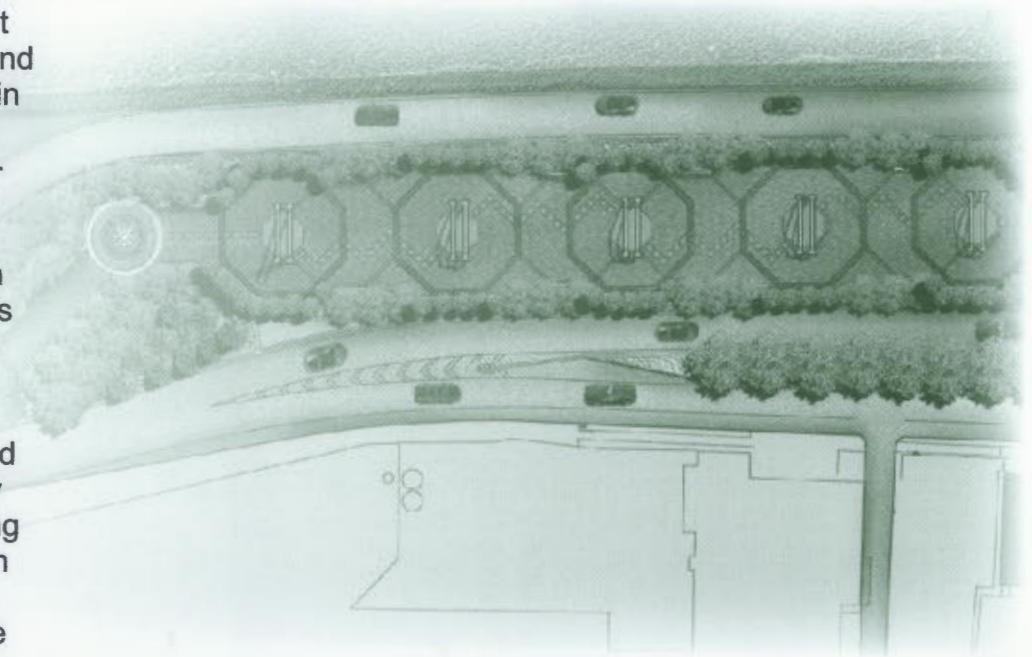

Route 29 deck park plans, Trenton.



## **Regional Planning and Coordination**

### **North Jersey Transportation Planning Authority (NJTPA), Inc.**

Counties: Bergen, Essex, Hudson, Hunterdon, Middlesex, Monmouth, Morris, Ocean, Passaic, Somerset, Sussex, Union, Warren (6,000,000 people)

Joel S. Weiner, Executive Director

One Newark Center, 17th Floor

Newark 07102

(973) 639-8400; FAX (973) 639-1953

### **Delaware Valley Regional Planning Commission (DVRPC)**

Counties: Burlington, Camden, Gloucester, and Mercer (and part of Pennsylvania under a bistate contract)

John J. Coscia, Executive Director

The Bourse Building, 8th Floor

111 S. Independence Mall, East

Philadelphia, PA 19106-2515

(215) 592-1800; FAX (215) 592-9125

[jcoscia@dvrpc.org](mailto:jcoscia@dvrpc.org)

[www.dvrpc.org](http://www.dvrpc.org)

### **South Jersey Transportation Planning Organization (SJTPO)**

Counties: Atlantic, Cape May, Cumberland, Salem

Timothy G. Chelius, Executive Director

1173 East Landis Avenue

Vineland 08360-4213

(856) 794-1941; FAX (856) 794-2549

### **I-95 Corridor Coalition**

The I-95 Corridor Coalition advances the intelligent transportation systems of its membership of state, local and regional agencies.

NJDOT is a member of this Maine-to-North Carolina organization.

John Baniak, Executive Director

6850 Versar Center, Suite 350

Springfield, VA 22151

(518) 584-4826; FAX (413) 502-8226

[i95cc@aol.com](mailto:i95cc@aol.com)

[www.I95coalition.org](http://www.I95coalition.org)



# Research & Technology

Research and technology facilitate value-added quality solutions to problems. NJDOT works with university, professional and business partners to develop new products and techniques for our transportation system.

There are currently more than 70 transportation research projects dealing with infrastructure, traffic, safety, operations support, human factors, and transit, including:

- rut testing with modified superpave mixtures
- early strength concrete mixes for pavement and bridges and concrete maturity
- adaptive control strategies for traffic signals
- infrastructure costs attributed to commercial vehicles
- integral abutments, continuity connections and circular elastomeric bearings
- traffic flow with 55 and 65 mph speed limits
- technologies to reduce harmful diesel emissions from trucks and buses
- non-emitting hydrogen fuel cell systems in NJDOT equipment
- fog sensor system to alert traffic managers
- crosswalk lighting system

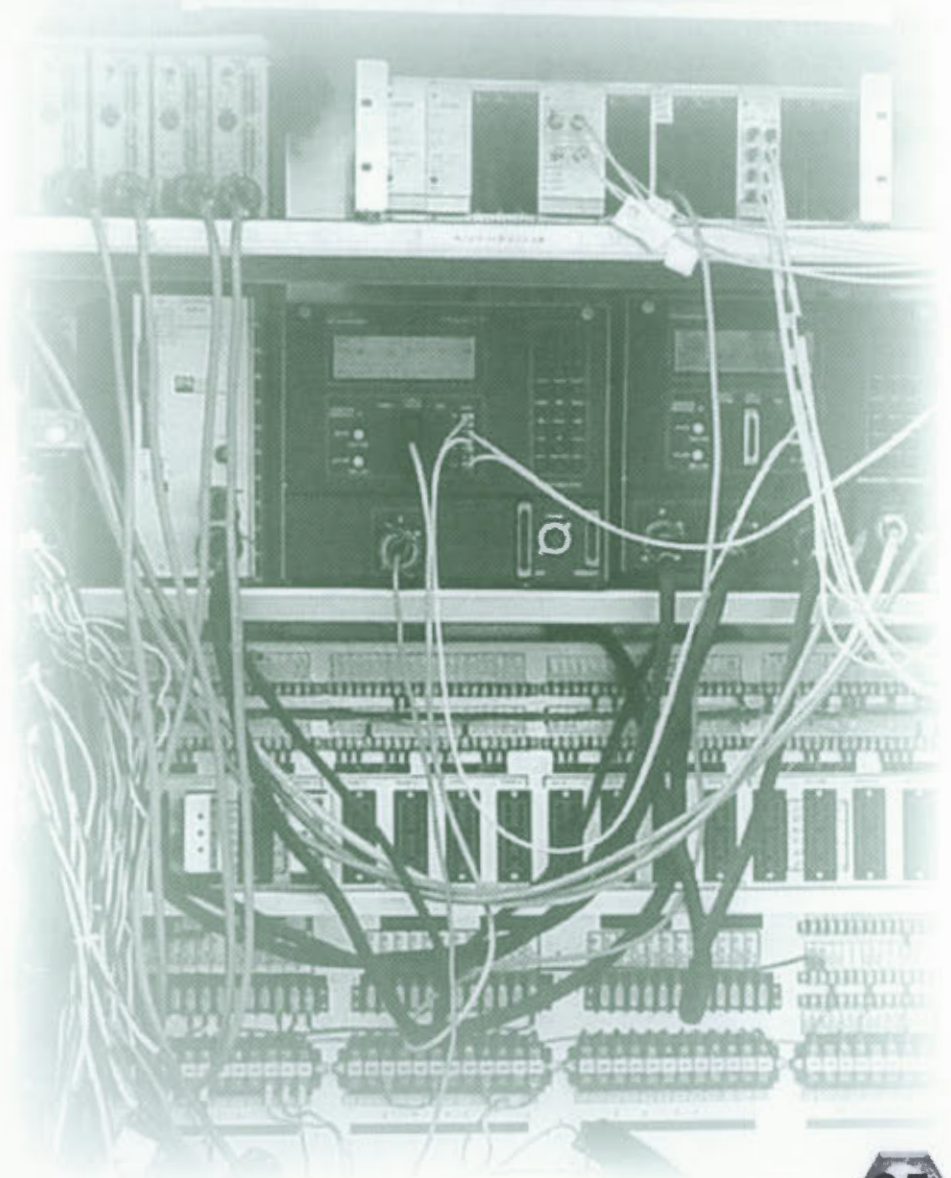



# Transportation Demand Services

The objective of Transportation Demand Measures (TDM) is to develop services and programs which will reduce the reliance on single occupant vehicles, reduce vehicle trips and miles of travel. These services and programs contribute to reducing traffic congestion and supporting more livable communities by:

- increasing the public's knowledge and benefits of a wide variety of transportation alternatives
- finding new TDM tools and strategies; analyzing legal impediments as well as technology advances
- ensuring that park and ride facilities are safe, convenient and fairly priced
- ensuring that NJDOT studies and projects consider bicyclist and pedestrian needs, and that information on bicyclist and pedestrian facilities and safety are widely distributed
- providing technical assistance and planning guidelines to communities interested in improving mobility around transit stations or bus stops (the Transit Village Program)



## Commute Options

One of the key ways that a commuter's reliance on single occupant vehicles for travel to work can be reduced is to provide more options. Our Commute Options program covers modes of transportation beyond traditional single person auto and transit travel. The services we provide include rideshare matching, NJ TRANSIT's Vanpool Sponsorship Program, the Park-Ride Program and Challenge Grant shuttles.

To help commuters understand all of the options that they have available to them, we have established a Web site, [www.njcommuter.com](http://www.njcommuter.com), to provide information on carpooling, vanpooling, public transit and park and ride locations to the general public.

The Web site serves to provide commuters a rideshare matching application, a vanpool application (if commuting distance is greater than 12 miles), a list of park-ride locations throughout the state and helps commuters calculate their cost savings for ridesharing based on mileage, the number of riders and the price of gasoline.

NJDOT administers the rideshare matching system, the nine Transportation Management Associations (TMAs) provide follow-up and assist commuters directly. There are currently 14,608 commuters in the rideshare-matching database. In 2001, the 14,000 applications received, 18 percent of all applicants were placed in a carpool. When adjusted for transit and vanpool placements through TMAs, the placement rate jumps to 31 percent.



## Bicyclists

### Bicycle safety

Bike safety fun for school children and manuals for their parents are available at

[www.state.nj.us/transportation/publicat/FUNPACK\\_/game](http://www.state.nj.us/transportation/publicat/FUNPACK_/game)

### Bicycle Accommodations

2,000 more miles of facilities for bicycling is the NJDOT goal for the year 2010. The following projects are underway.

TYPE	MILES	EXAMPLE
Delaware & Raritan Canal State Park	12	FY 99-00 only "Gaps," e.g. trail bridge over Route 1
Projects in Development	475	Independent improvements initiated by NJDOT, e.g. Route 94 (0-27.7)
Transportation Enhancements	100	Federal funds for nontraditional transportation projects
National Recreational Trail System (NJDEP)	65	FY 99-01 Federal funds for multi-use trails selected by Trail Council, e.g. Pemberton Trail

Local bicycle projects	318	FY 99-01 Trust Fund \$9,000,000 awarded for FY 01, various trails and bike compatible road improvements
------------------------	-----	---

State park projects	67	Independent projects initiated by NJDOT/ NJDEP
---------------------	----	--

Fast track bicycle accommodations	279	Independent bicycle compatibility project initiated by NJDOT
-----------------------------------	-----	--



NJDOT published nine new tour guides in 2003. They are available at [www.njdot.nj.gov](http://www.njdot.nj.gov).



## New Jersey Bicycle Advisory Council

The New Jersey Advisory Council, established in 1995 following a recommendation of the State Bicycle and Pedestrian Master Plan, is composed of representatives of the bicycling community and the public agencies and organizations that will guide the implementation of the plan.

The following agencies participate: the Governor's Office of Policy and Planning, NJDOT and NJ TRANSIT; the Departments of Environmental Protection, Community Affairs, Education, Law and Public Safety; the Metropolitan Planning Organizations; the County Planners and Engineers Associations; the League of Municipalities and bicycling organizations.

## Pedestrian safety study intersections

This is a special initiative to address pedestrian safety at key locations. In the second round, improvements are being developed at the following locations:

INTERSECTION	COUNTY
County Route 501 (JFK Blvd.) at 15 <sup>th</sup> Street, Bayonne City	Hudson County
Echelon Road at Kirkbride Road, Voorhees Township	Camden County
Atlantic Avenue at Michigan Avenue, Atlantic City	Atlantic County
Atlantic Avenue at Kentucky Avenue, Atlantic City	Atlantic County

County Route 39 (South Washington Avenue)  
at County Route 70 (West Main Street),  
Bergenfield

Bergen County

County Route 606 (Hamilton Avenue)  
at Clinton Avenue, Trenton

Mercer County



## Smart Moves For Business

This program was initiated in March 1998. It is a statewide regulatory initiative (N.J.A.C. 16:50) to stimulate and support New Jersey employers to take actions that encourage voluntary participation in commute options. The regulation articulates the procedures for employers to follow as they register with the Department for tax credit eligibility and to apply for challenge grants for innovative commute strategies. These procedures are not complex or time-consuming and they serve as incentives for employer participation.

The Department has awarded \$300,000 in challenge grants for five employer-based shuttle projects. There are two active shuttles operating. The program has \$380,000 available for new applications.

While employees at only a few dozen worksites chose to take advantage of the employer tax credits in prior years, we are developing ways to market the new federal tax benefits to employers. The federal tax benefit program is called "Commuter Choice."



## WorkFirst New Jersey

NJDOT partners with NJ TRANSIT, the Departments of Human Services and Labor and the State Employment and Training Commission to respond to the transportation needs of participants by eliminating transportation barriers to employment.

Since 1997 every county has maintained a comprehensive transportation coordination plan that integrates public transportation and community services to improve the effectiveness of both. These county plans form the basis for eligibility for state Transportation Innovation Funds, the Federal Transit Administration's Job Access and Reverse Commute (JARC) program and the Department of Human Services' WorkFirst New Jersey Transportation Block grants.

Under the JARC program, New Jersey received approximately \$3,700,000 in federal funds for two dozen projects throughout the state. In addition, NJ TRANSIT has submitted grants requesting an additional \$3,600,000 in federal funds to continue and expand these projects. For more information on JARC, please contact program coordinator James Flynn at (973) 491-7382.

NJDOT, NJ TRANSIT, and the NJ Department of Human Services also partner to provide transit passes to eligible individuals. In the first eleven months of 2002 approximately 59,000 monthly passes were distributed, along with approximately 144,000 one-way tickets. For 2002 this program has brought in nearly \$3,500,000 in additional revenue. For more information on this program, please call Louis Capadona at NJ TRANSIT at (973) 491-7109.

## Transit Villages

The Transit Village program is based on the concept that neighborhoods can be enhanced by train stations and other mobility investments, and through them revitalize its infrastructures and economic development. Creation of Transit Villages also can increase transit ridership.

The five transit villages in the first tier of this new program are South Amboy, Rutherford, South Orange, Morristown and Pleasantville. Riverside is in the second tier.

For more information, please contact program coordinator Monica Etz at (609) 530-5957.

## Transportation Management Associations (TMAs)

The nine transportation management associations (TMAs) are private, nonprofit organizations that provide services to employers, commuters and others to reduce trips, increase transit and ridesharing and reduce vehicle miles traveled on New Jersey roads. Their mission statements and service areas are determined by a Board of Directors/Trustees with six to ten private and public members. TMA programs are mostly geared to improve transportation choices. They may promote and broker carpooling, vanpooling, bicycling, walking, shuttle services and alternative work schedules.

TMAs also participate in the Department's WorkFirst New Jersey, Ozone Action Partnership and Electric Car Station programs.

BUDGET: \$3,300,000 – \$3,500,000 annually for operating expenses for specific activities under federal guidelines. TMAs each received between \$348,000 and \$670,000 in 2001-2002. They are funded by NJDOT at approximately 80 percent, except Transit Plus, funded almost entirely by NJ TRANSIT. Work programs are approved in cooperation with the Federal Highway Administration. For more information please call Paul Thomas at (609) 530-8039.



Rutherford Station



<b>TMA</b>	<b>Executive Director</b>	<b>Phone; FAX</b>	<b>E-Mail</b>	<b>Web (www)</b>
<b>Cross County Connection</b> Greentree Executive Campus 2002 D Lincoln Dr. W Marlton 08053	William Ragozine	(865) 596-8228; FAX (865) 983-0388	ccctma@transportationchoices.com	transportationchoices.com
<b>Greater Mercer TMA</b> 15 Roszel Rd. Princeton 08540	Sandra Brillhart	(609) 452-1491; FAX (609) 452-0028	tma@gmtma.org	gmtma.org
<b>Hudson TMA</b> Peninsula at Bayonne Harbor Foot of 32 <sup>nd</sup> St., Route 440 Bldg. 82, Rm. 189, Unit 6 Bayonne 07002	Suzanne Mack	(201) 339-0078; FAX (201) 339-8411	traffic@hudsontma.org	hudsontma.org
<b>Hunterdon Area Rural Transit</b> 84 Park Avenue Flemington 08882	Tara Braddish	(908) 788-5553; FAX (908) 788-8583	info@hart-tma.com	hart-tma.com
<b>Keep Middlesex Moving</b> 100 Bayard St. 2nd fl. New Brunswick 08901	Peter Cantu	(732) 745-4465; FAX (732) 745-7482	KMM@kmm.org	kmm.org
<b>Meadowlink Commuter Services</b> 201 Route 17N Rutherford 07070	Krishna Murthy	(201) 939-4242; FAX (201) 939-2630	info@meadowlink.org	meadowlink.org
<b>RideWise of Raritan Valley</b> 166 W. Main St. Somerville 08876	Nancy Jusko	(908) 704-1011; FAX (908) 704-1494	nancy@ridewise.org	ridewise.org
<b>Transit Plus of Essex &amp; Union</b> One Penn Plaza Newark 07015	Lou Capadona	(973) 491-7109; FAX (973) 491-8881	lcapadona@njtransit.com	njtransit.com
<b>TransOptions</b> 2 Ridgedale Ave., Suite 200 Cedar Knolls 07927 (formerly McRides)	John F. Ciaffone	(973) 267-7600; FAX (973) 267-6209	info@transoptions.org	transoptions.org





