

974.905
L6 & c. 1

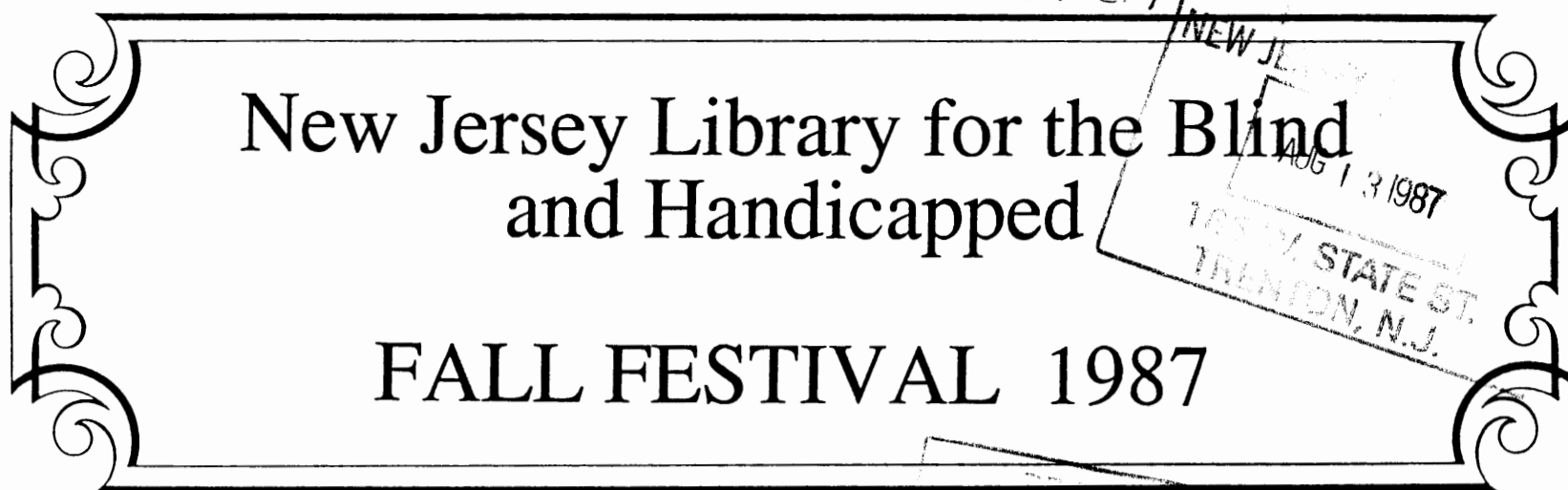

The Library will host its fifth annual Fall Festival Saturday, September 19, from 10 a.m. to 4 p.m. Many of the day's activities have become annual events because of their popularity with the hundreds of visitors that come every year. We're sure that as you look through this brochure you'll find something special that will especially interest you.

There will be two different children's programs during the day. These will be held at the same time as the adult programs so children will be kept safely occupied while their parents are enjoying the speakers.

Those who are spending the day at the Festival can bring a lunch or purchase a light meal from our Snack Bar. It is also possible to order a box lunch in advance by using the form on page three.

This year the Library has arranged transportation from 17 counties. There will be a small charge for all county transportation, payable in advance to the Library. If you are interested in using county transportation, please complete the form on page three by checking off the pick-up point you will use in your county. Your county transportation provider will contact you with final arrangements and pick-up times. For those coming by train, New Jersey Transit will provide assistance at both the Trenton and the Newark stations.

The Fall Festival is the Library's opportunity to meet those who use the program and to offer a day that is fun and informative. The Staff invites you all to attend this year's Festival. We think you'll be glad you did!

SCHEDULE OF EVENTS

10:00 a.m. EXHIBITS OPEN

Exhibits by agencies and companies providing appliances, and services for the handicapped. Exhibits will be open all day.

10:00 a.m. 4-H PETTING ZOO **Front Walk**
Favorite domestic animals available to be held, fed, and ridden.

10:30 a.m. BOB ASKEY **Cafeteria**
Voted by readers as the winner of the first annual Alexander Scourby Narrator of the Year Award, Mr. Askey will speak on Talking Books from the narrator's point of view.

10:30 a.m. CRAFTS **Kid's Corner**
Children of all ages are invited to get to know each other and enjoy some crafts with Children's Librarian Karen Thomas.

1:00 p.m. SEEING EYE PUPPIES **Front Walk**
Youngsters who are raising future dog guides for the blind will demonstrate their pups' skills.

2:00 p.m. FRANK KURT CYLKE **Cafeteria**
The Director of the National Library Service for the Blind and Physically Handicapped in Washington will review the current program and speak of plans for the future.

2:00 p.m. JIM ALBERTSON **Kid's Corner**
A professional singer and storyteller, Mr. Albertson will tell tales of New Jersey.

FALL FESTIVAL 1987 MAP

ENTRANCE

Petting Zoo and Puppy Demonstration

1 VESTIBULE

Information/Tours
Lunch Tickets

2 MAIN LOBBY

Eye-Openers
Governor's Committee on the Disabled
Maxi-Aids
NFB of New Jersey
New Jersey Association for the Deaf/Blind
National Association Parents of Visually Impaired -- NJ Chapter
New Jersey Blind Men's Association
New Jersey Council of the Blind
Recording for the Blind
RP Foundation Fighting Blindness
SCRIP

3 MAIN HALL

AFB
Friends of the Library
Library "What in the World" Contest
Sense-Sations

4 REAR HALL

Box lunches and tables for lunch

5 REFERENCE ROOM

Contact
DIAL
New Jersey Commission for the Blind
NJ Transit
Radio Shack
Summit Computer
Visionaries

6 CONFERENCE ROOM

Aids Unlimited
Peripheral Technologies
Science Products
Sensory Aids Corp
V-Tek

7 CAFETERIA

Snack Bar (Will be closed 10:30-11:30 a.m. & 2:00-3:00 p.m.)
Unlimited Coffee and Tea
Bob Askey (10:30 a.m.)
Frank Kurt Cylke (2:00 p.m.)

8 KIDS' CORNER

Arts and Crafts (10:30 a.m.)
Jim Albertson (2:00 p.m.)

9 READING ROOM

Library Aids and Appliances
Readers' Advisors
Equipment Return and Exchange

10 HANDICAPPED PARKING AREA

NJ Transit Accessible Bus

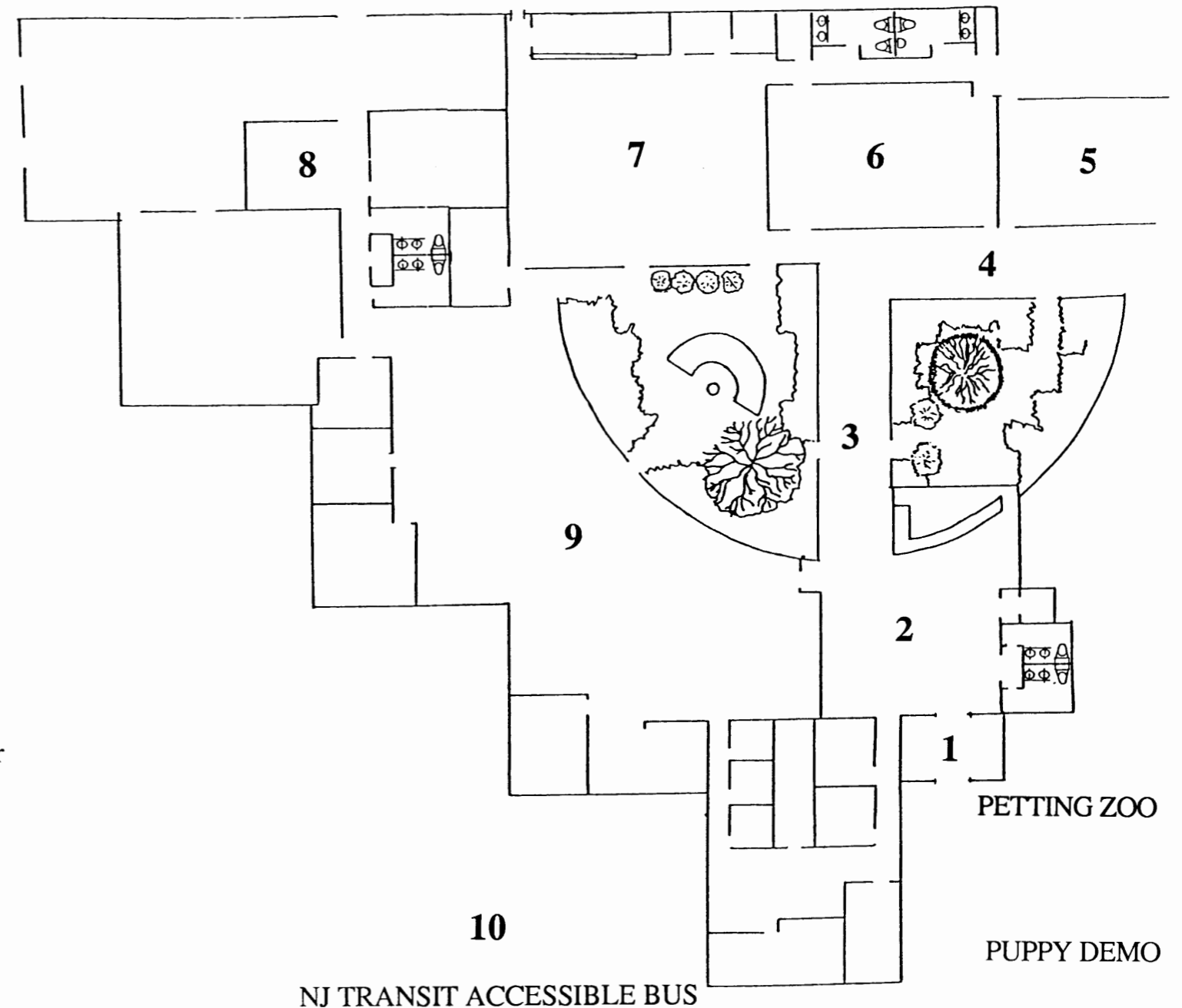

FALL FESTIVAL 1987 ORDER FORM

Name _____ Phone _____

Address _____

Town _____ County _____

1. Yes No Please send directions to the Library.

2. Yes No Please order box lunches for the Fall Festival:

Ham and Cheese _____ x \$3.50 = _____

Roast Beef _____ x \$3.50 = _____

3. Yes No Please arrange transportation to the Festival:

ATLANTIC COUNTY. _____ x \$4.00 = _____

____ Atlantic City Bus Station Pick Up
 ____ Shore Mall Parking Lot Pick Up

BERGEN COUNTY. _____ x \$5.00 = _____

____ Hackensack Bus Station Pick Up
 ____ Door to Door Pick Up

BURLINGTON COUNTY. _____ x \$3.00 = _____

____ Lumberton Plaza Pick Up
 ____ Burlington Center Pick Up

CAMDEN COUNTY. _____ x \$4.00 = _____

____ Westmont Plaza Pick Up

CAPE MAY COUNTY. _____ x \$5.00 = _____

____ Rio Mall Pick Up
 ____ Jamesway Plaza Pick Up
 ____ Cape May Court House Pick Up

CUMBERLAND COUNTY. _____ x \$4.00 = _____

____ Door to Door Pick Up

ESSEX COUNTY. _____ = No Charge

____ Door to Door shuttle bus to and from Pennsylvania
 Station in Newark

GLOUCESTER COUNTY. _____ x \$4.00 = _____

____ Door to Door Pick Up

HUNTERDON COUNTY. _____ x \$4.00 = _____

To be determined after county receives list of those needing service.

MERCER COUNTY. _____ x \$3.00 = _____

____ Door to Door Pick Up

MIDDLESEX COUNTY. _____ x \$3.00 = _____

____ Menlo Park Shopping Center Pick Up
 ____ East Brunswick Square Mall Pick Up
 ____ Caldor Shopping Center -- North Brunswick Pick Up

MONMOUTH COUNTY. _____ x \$4.00 = _____

____ Office of the Handicapped -- Freehold Pick Up
 ____ Jersey Shore Medical Center Pick Up

MORRIS COUNTY. _____ x \$5.00 = _____

____ Morris County Free Library Pick Up
 ____ Door to Door Pick Up

OCEAN COUNTY. _____ x \$4.00 = _____

To be determined after county receives list of those needing service.

PASSAIC COUNTY. _____ x \$4.00 = _____

____ Door to Door Pick Up

SUSSEX COUNTY. _____ x \$4.00 = _____

____ Door to Door Pick Up

UNION COUNTY. _____ = No Charge

____ Door to Door shuttle bus to and from nearest train station.

TRENTON TRAIN STATION _____ = No Charge

____ Shuttle bus between train station and the Library;
 Available to residents of any county if reserved in advance.

Please return this form on or before September 4 with a check made payable to the Library for the Blind and Handicapped, 2300 Stuyvesant Avenue, Trenton, New Jersey 08618.



WHAT'S FOR SALE?

You may have to walk a little farther to find them, but they will again be at the Fall Festival. "They" are the Friends of the Library who have moved their booth from the lobby to the main hall of the Library. Make sure you stop to check out the goodies for sale this year. Once again tote bags and Braille mugs will be available. A new item this year will be bumper stickers, designed with the help of the Library's readers who submitted entries to a contest held earlier in the year. All items are reasonably priced, useful, and very attractive. If you would like to take home a reminder of your visit to the Library or pick up an unusual gift item, be sure to visit the Friends' booth in the main hall.

WHAT IN THE WORLD?

The Library has put together a challenging contest for the 1987 Fall Festival with a dozen next-to-impossible-to-recognize objects on hand to be identified. Each is a useful item that will probably be as difficult to recognize with sight as it is without. Entry forms and a page of not very helpful clues will be available in Braille or large print at the Library table in the main hall with prizes for those who can identify the most items.

A quarterly publication of
The New Jersey Library
 for the
Blind and Handicapped
 2300 Stuyvesant Avenue
 Trenton, New Jersey 08618

Editor: Christine Lisiecki

**FREE MATTER
 FOR THE
 BLIND AND HANDICAPPED**



**COME TO THE
 FALL FESTIVAL** →