

974.901  
S88  
c.3

# ANNUAL REPORT

PROPERTY OF  
NEW JERSEY STATE LIBRARY

AUG 22 1983

## JULY 1, 1982 TO JUNE 30, 1983

85 W. State St.  
Trenton, N. J.

### BUREAU OF STATE USE INDUSTRIES

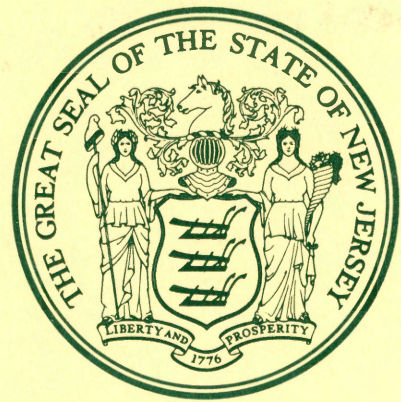

STATE OF NEW JERSEY  
DEPARTMENT OF CORRECTIONS

CN 867, 111 OAK STREET  
TRENTON, NEW JERSEY 08625

New Jersey State Library

ANNUAL REPORT, BUREAU OF STATE USE INDUSTRIES 1982-1983

TO Mr Herbert B. Blumenthal  
Assistant Commissioner  
Division of Administration

FROM Lucas J. Filipponi, Chief  
Bureau of State Use Industries



The following Annual Report is a summary of the Bureau of State Use Industries activities for the fiscal period ending June 30, 1983.

A "line and staff" relationship exists between this Bureau and the industrial operating units within the Department of Corrections. The cooperation that exists between State Use Industries and other agencies and institutions is a significant factor in the success of the Bureau's industrial program.

Department Standard 610, mandates this Bureau to provide staff technical services, capital equipment and finances required to maintain a diversified, on-the-job industrial training operation. Useful products manufactured by the industries are sold to tax supported agencies in New Jersey. State Use Industries does not receive appropriated funding and is therefore self-supporting. The industries are operated with the aid of a Revolving Fund (R.S. 30 4-100) and the program is financed exclusively from earned profits.

The Bureau of State Use Industries was created by the Legislature under the Laws of 1918. The Bureau operates under legislative powers currently vested in the Commissioner of Corrections (R.S. 30 4-4 and R.S. 30 4-92 thru 100). State Use Industries was reassigned as a unit within the Division of Administration when the Department of Corrections was established in November 1976.

ADMINISTRATIVE HIGHLIGHTS AND ACCOMPLISHMENTS (continued)

The Bureau assisted the Division of Motor Vehicles in developing specially designed plates for County Officer, Freeholder, County Clerk, Surrogate and Sheriff, which required special tooling. In addition, the "MD" plate was redesigned to include the word "Physician".

The Bureau produced and delivered for the Division of Taxation, Motor Fuel Transport license plates.

Acquisition of a Halm Jet Envelope Press enabled the Bureau to meet increasing customer demand for printed envelopes. Given the production capabilities of the Jet Press, idle time during production has been significantly reduced, shortening the duration of open customer orders.

1,810 mattresses were manufactured for New Jersey's correctional facilities as part of the mattress replacement program. Appropriation of funds for the replacement program were provided through the Department of Corrections.

Our finished product stocking program enabled us to meet the continuous demand for replacement mattresses, as well as new bedding requirement for the increasing inmate population.

It has been the Bureau's goal to obtain a ticking material that is flame retardant, durable and cost effective. Presently, various types of ticking material are being evaluated for the Department's correctional setting.

On November 8, 1982 Kathy Gandolfo of WPVI-TV Philadelphia and James Stabile of the Department of Corrections visited the State Use Warehouse for the purpose of filming the flame retardant mattress. This film clip appeared on the 5 P.M. News graphically depicting the safety elements of New Jersey's flame retardant mattress.

Extensive repairs were made to the roof of the Machine and Bed Shop at the State Prison, Rahway, thus supplying the instructors and inmates with an expanded area for production. In addition, various housekeeping projects have been completed, providing for an improved organization of material and supplies.

Meetings were conducted with the Department of Corrections Central Office staff and the Superintendent of Rahway, to discuss the programs State Use intends to place in the existing Rahway Laundry Building. Recommendations were made for expansion programs and possible addition of new industries. Blueprints and shop layouts have been completed and are currently in review.

The Bureau of State Use Industries has been considering the possibility of placing industries at YCI-Annandale. These ideas were discussed at a meeting held with the Superintendent of Annandale and the Division of Administration.

## ADMINISTRATIVE HIGHLIGHTS AND ACCOMPLISHMENTS (continued)

Progress is continuing in our effort to install vertical storage systems throughout the warehouse, enlarging our finished product stocking program. The boiler building adjacent to the warehouse is being emptied and has been designated for use as an additional storage area. In addition, to increase the efficiency of our trucking operation and the security of our vehicles, the S.U. Central Warehouse overhead door was enlarged allowing trucks to be parked in the building overnight.

Through a cooperative arrangement between State Use and Jones Farm the inmate detail has been increased and maintained at a steady level throughout the year. The availability of a steady detail from Jones Farm enables the Bureau to proceed with routine grounds maintenance and warehouse projects.

Mr Meyer Kleinwaks, Supervising Institutional Trade Instructor (Clothing), State Prison-Rahway, was one of the five finalists for the Correctional Industries Association National Achievement Award for "Supervisory Excellence". This is the second consecutive year that a State Use employee has been nominated for this prestigious award.

The Bureau continues to maintain its association with the American Correctional Association through its affiliation and active participation with the Correctional Industries Association and the Northeast Correctional Industries Association.

The writer was elected to the Correctional Industries Association Board of Directors at the A.C.A. Conference in Toronto. Recently, he was appointed as Third Vice-President of the Correctional Industries Association and will represent the New Jersey Department of Corrections at the upcoming A.C.A. Conference in Chicago.

The Bureau has had numerous meetings with N.J. Transit Corp. for specially designed Bus Stop and Railroad Building signs. Orders have been received and are in production.

Meetings were held with various vendors and other sources in an effort to compile data and equipment information necessary for the upgrading and expansion of our industrial program.

New Jersey Assembly Bill No. 1894 which would exempt "Counties and County Institutions" from the requirement to purchase articles and/or supplies manufactured by State Use Industries has been tabled by the Assembly, which if passed would have been a serious detriment to our operation.

In light of the Surface Transportation Act, in which section 114(b) prohibits the use of prison made products or services on Federally Funded highway projects, the Bureau has made a concentrated effort to support the action of the Correctional Industries Association and the State's Legislative Liaison to amend this section.

## ADMINISTRATIVE HIGHLIGHTS AND ACCOMPLISHMENTS

In an attempt to constantly reassess the needs of the Department and our customers, considerable time and effort was devoted to the reassigning of products. Based on this analysis, decisions were made in Fiscal Year 1982 to implement changes, consequently increasing production.

The following Fiscal Year 1982 decisions were implemented

- A. Addition of work pants line at Leesburg Clothing Shop
- B. Increased cloth cutting capability, accommodating the increased demand of our clothing line.
- C. Transferred the Cotton Mop Head production line from Clinton to Yardville, consolidating our Janitorial/Maintenance products industries.
- D. Transferred Jacket production from Trenton to Clinton, Leesburg and Rahway (Clothing).
- E. Expansion of the printing operation at the Oak Street facility
- F. Our stocking program of finished products in the Central Warehouse is now 70% complete
- G. Replacement and upgrading of obsolete equipment throughout our industrial program

At the request of the Department of Human Services, the Bureau has developed several lines of dresses, blouses and men's shirts per their specifications. Samples of these items have been supplied and approved, orders are expected in F Y 1984

State Use met with representatives of the Purchase Bureau Distribution Center and proposed an arrangement whereby the Distribution Center would stock our Mop and Brush product line. Several meetings will be scheduled to finalize this proposal.

A major effort was undertaken to repackage 400,000 pair of license plates in an odd-even series for the Division of Motor Vehicles, thereby enabling them to institute the odd-even inspection system

The State Legislature enacted a law requiring Mopeds to be licensed and registered with the Division of Motor Vehicles. State Use was called upon to develop a Moped license plate. In response, the Bureau developed, produced and delivered an initial quantity of 50,000 plates for distribution, enabling the Division of Motor Vehicles to meet the implementation deadline set forth by law

ADMINISTRATIVE HIGHLIGHTS AND DEVELOPMENTS (continued)

In an effort to increase the marketing impact at the League of Municipalities Convention in Atlantic City, the Bureau expanded its display to a double booth. A large variety of products were exhibited, enabling conventioners to physically handle and inspect our product line. More than 800 visitors throughout the state registered at the exhibit and were given a promotional information package.

The Bureau continues to reach its market through the mailing of special flyers, brochures and other promotional literature.

Central Office staff completed 143 visitations during this fiscal year and travelled 27,277 miles during this period. In addition, State Use Industries operated 6 trucks for the delivery of products. These vehicles travelled a total of 68,347 miles. The total mileage of 95,624 is 946 miles more than last year

PERSONNEL ACTION

During the past fiscal year the Bureau hired 13 new employees. Four staff members retired and the Bureau accepted the resignation of 3 employees. There were 2 employees discharged and 2 transferred to other State agencies. Irving Seligman, Chief of the Bureau retired after some 20 years of service.

INDUSTRIAL PROGRAM

State Prison, Trenton

Clothing  
Knitting  
Machine  
Mattress  
Printing

Youth Corr Inst., Bordentown

Metal Fabrication  
Soap

Correctional Inst. for Women,  
Clinton

Clothing

State Prison, Rahway

Clothing/Textiles  
Machine & Bed  
Signs & Industrial Finishing  
Miscellaneous Manufacturing (Furniture)

State Prison, Leesburg

Auto Tag  
Clothing

Youth Reception & Corr. Center  
Yardville

Miscellaneous Manufacturing (Brushes)  
Mop

Oak Street Facility  
Trenton

Central Office  
Warehouse  
Trucking  
Printing

## INMATE EMPLOYMENT

The industries employed a total of 1847 inmates, approximately 11% of the resident population and worked 246 days during the fiscal year. The Bureau operated 17 industries at 6 institutions.

The average number of inmates employed rose from last year's average of 461 to 488 inmate workers. The turnover rate per job has increased to an annual rate of 3.8 inmates per job assignment. There were 1320 new workers assigned and 1242 inmates dropped during the fiscal year.

	<u>Average Full Time Jobs</u>				<u>Inmates Assigned During Year</u>				<u>Average Inmates Per Job</u>			
	<u>80</u>	<u>81</u>	<u>82</u>	<u>83</u>	<u>80</u>	<u>81</u>	<u>82</u>	<u>83</u>	<u>80</u>	<u>81</u>	<u>82</u>	<u>83</u>
Prison	103	108	80	100	208	239	356	489	2.0	2.2	4.5	4.9
Rahway	101	89	122	135	288	306	327	436	2.9	3.4	2.7	3.2
Bordentown	63	55	60	54	258	224	257	236	4.1	4.0	4.3	4.4
Clinton	47	48	59	58	144	176	169	190	3.1	3.6	2.9	3.3
Yardville	14	16	22	22	51	64	88	94	3.6	4.0	4.0	4.3
Leesburg	104	103	118	119	327	387	422	402	3.1	3.7	3.6	3.4
	<u>432</u>	<u>419</u>	<u>461</u>	<u>488</u>	<u>1,276</u>	<u>1,396</u>	<u>1,619</u>	<u>1,847</u>	<u>3.0</u>	<u>3.5</u>	<u>3.5</u>	<u>3.8</u>

Inmate Daily Wage rates are paid in conformance with Administrative Order 1 21-4 and Standard #620. The last increase in industry base rates occurred November 1, 1982 at the rate of 10¢ per day.

	<u>Below Average</u>	<u>Average</u>	<u>Above Average</u>
15% Skilled	\$1.30	\$1.35	\$1.40
45% Semi-Skilled	1.20	1.25	1.30
40% Unskilled	1.10	1.15	1.20

Those industries at Yardville utilize the daily wage rate and receive a bonus of 25¢ per day to inmates working a minimum of 5 hours daily.

INMATE EMPLOYMENT (continued)

The Hourly Wage rate is in effect at State Use industries located in Clinton, Leesburg, Rahway, Bordentown and Warehouse operation (111 Oak St.). The Bureau policy is "NO WORK - NO PAY" regardless of the reason for absence! The following hourly wage rates are currently paid

15% Skilled	"A" rate	54¢ per hour
45% Semi-Skilled	"B" rate	44¢ per hour
40% Unskilled	"C" rate	29¢ per hour
Learner	"D" rate	24¢ per hour

Inmate Instructor Assistant 84¢ per hour

(This position is limited to qualified inmates only. Training is at management level and gradually requires the inmate to accept responsibility for operating the industry.)

The AM/PM rate is paid to the inmate work force at the State Prison, Trenton. Pay scale for the AM/PM work force is as follows (3 hrs. per Shift)

	<u>Below Average</u>	<u>Average</u>	<u>Above Average</u>
15% Skilled	\$2.15	\$2.25	\$2.35
45% Semi-Skilled	1.65	1.75	1.85
40% Unskilled	1.15	1.25	1.35
Learner	- \$1.10 for (2) months only (when necessary)		
Inmate Instructor Assistants	- \$3.10		

INMATE EMPLOYMENT SUMMARY

TOTAL EMPLOYED .. . . .	1847
% of Population . . . . .	11%
Number of Working Days . . . . .	246
Average Number Employed .. . . .	488
Number of Inmates Per Job Assignment .. . . .	3.8
Number of New Inmates Assigned to Payroll ..	1320
Number of Inmates Dropped from Payroll .....	1242

BUREAU OF STATE USE INDUSTRIES

	Units Mfd.	AM - PM Inmates Working	AM - PM Inmates Assigned	AM - PM Inmates Dropped	AM - PM Inmates Short
<u>State Prison, Trenton</u>					
Clothing	34,465 ea.	507 625	70 90	60 80	213 96
Knit	11,692 doz.	149 168	7 15	4 14	73 105
Machine	--- jobs	--- ---	--- ---	--- ---	--- ---
Mattress	12,819 ea.	157 155	11 11	9 6	29 28
Print	10,482,919 Impressions	225 236	19 32	21 23	132 121
Storeroom, Office, Runners		18 23	2 4	0 0	5 3
<u>Jones Farm</u>					
Central Warehouse-Printing	6,996,841 Impressions	23	5	7	21
" " Receiving & Shipping		131	50	39	54
		<hr/> 2,417	<hr/> 316	<hr/> 263	<hr/> 831
<u>State Prison, Rahway</u>					
Clothing/Textile	(Clothing) 32,025 ea (Textile) 186,728 ea	485	94	98	19
Machine & Bed	3,255 ea	323	57	57	0
Miscellaneous	7,341 ea	300	74	57	0
Paint & Sign	(Signs) 15,969 ea. (Posts) 9,575 ea	364	65	57	0
Storeroom, Office, Runners		159	31	36	0
		<hr/> 1,631	<hr/> 321	<hr/> 305	<hr/> 19
<u>State Prison, Leesburg</u>					
Auto Tag	2,111,933 ea.	393	77	70	2
Clothing	56,669 ea	1,031	225	232	23
		<hr/> 1,424	<hr/> 302	<hr/> 302	<hr/> 25
<u>Youth Corr. Inst., Bordentown</u>					
Metal Industries	15,091 ea.	502	114	126	158
Soap	363,440 lbs. 48,566 gals.	171	53	53	139
		<hr/> 673	<hr/> 167	<hr/> 179	<hr/> 297
<u>Corr Inst for Women, Clinton</u>					
Clothing	55,329 ea.	696	134	126	17
<u>Youth Recept. &amp; Corr Ctr, Yardville</u>					
Miscellaneous (Brush)	22,844 ea.	269	77	67	3
Mop	21,534 ea				
+ Represents grand total of working inmates reported on each monthly payroll	TOTALS	+ 7,110	1,317 * 530 <hr/> 1,847	1,242	1,192

\* Add average inmate work force available 7/1/82

## FINANCIAL STATISTICS

A physical inventory was taken on the last two days of the fiscal year in accordance with statutory requirements (RS 30 4-100).

The consolidated balance sheet and operating statement will be forwarded when they are finalized. Preliminary figures indicate another profitable operation for the 1982-1983 Fiscal Year.

## SALES

The Bureau's total sales volume in 1983 Fiscal Year reached \$5,133,911.10 and reflects a significant increase over last year's figures. Most noteworthy increases are attributed to the inmate population expansion in the Department of Corrections which required greater amounts of clothing, beds, footlockers, mattresses, etc. This consequently resulted in decreased sales revenue from other State Departments, Counties and Municipal accounts. The accompanying charts illustrate these sales trends.

HISTORY F Y. 1978-1983

DOLLAR VOLUME IN SALES

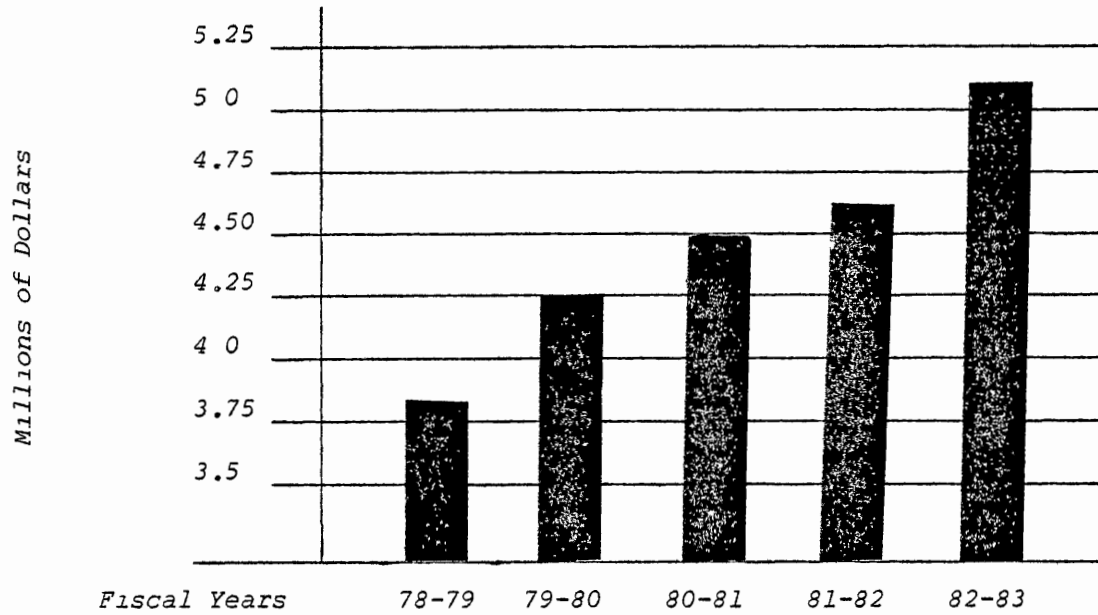

Percentage of change over past Fiscal Year +10%

HISTORY OF SALES

DEPARTMENT OF CORRECTIONS

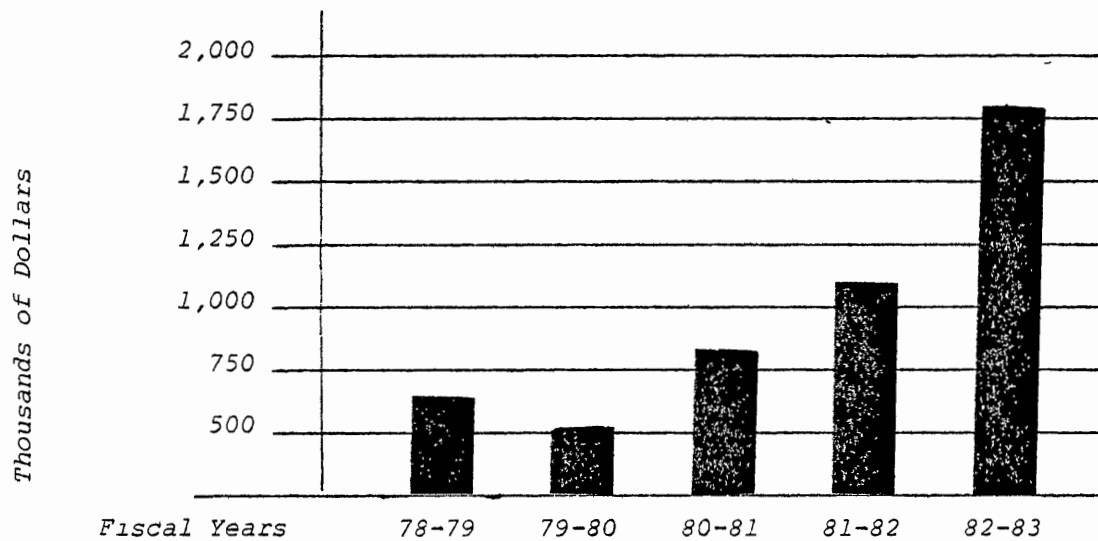

Percentage of change over past Fiscal Year +68%

HISTORY OF SALES

DEPARTMENT OF HUMAN SERVICES

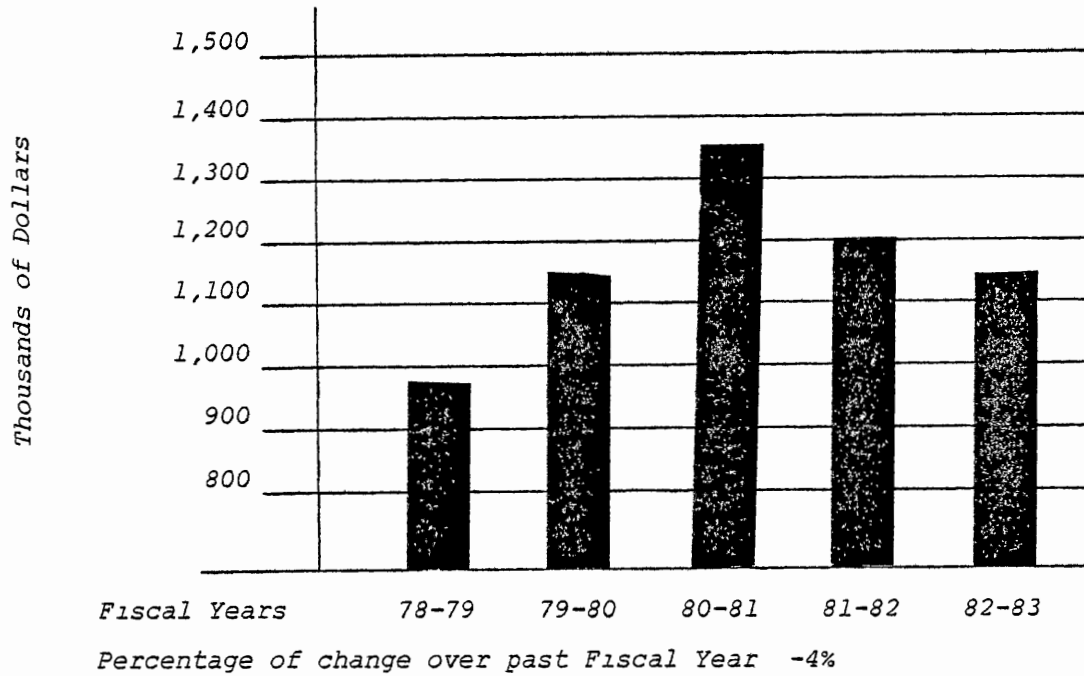

HISTORY OF SALES

OTHER STATE DEPARTMENTS

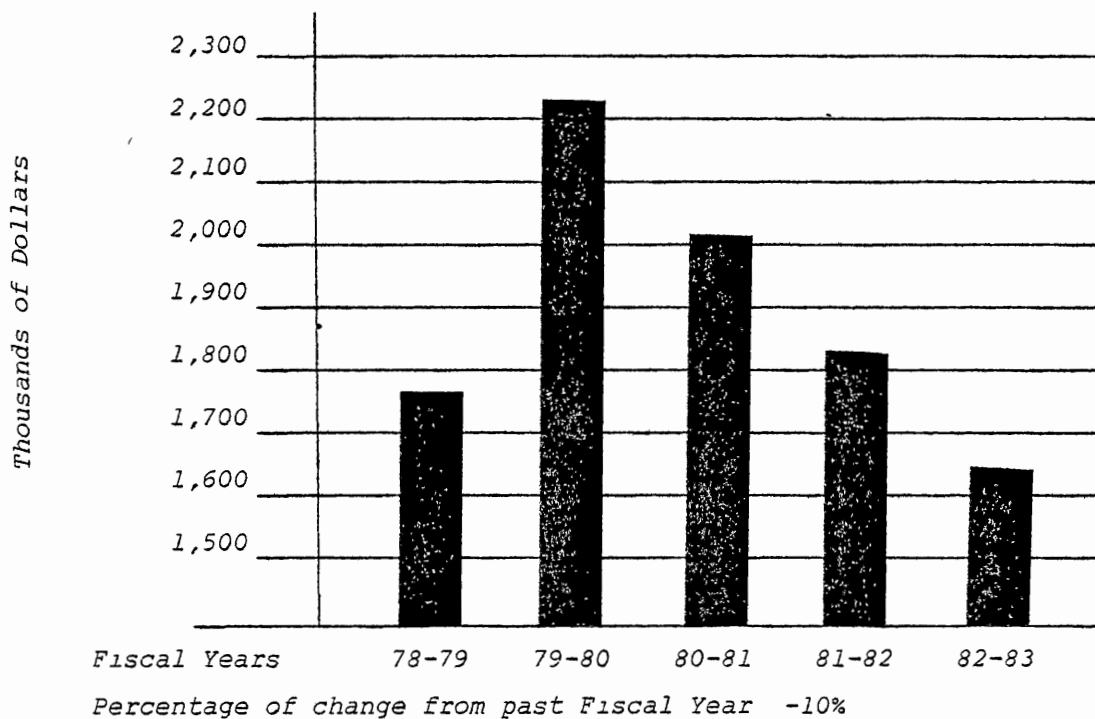

HISTORY OF SALES

COUNTIES AND MUNICIPALITIES

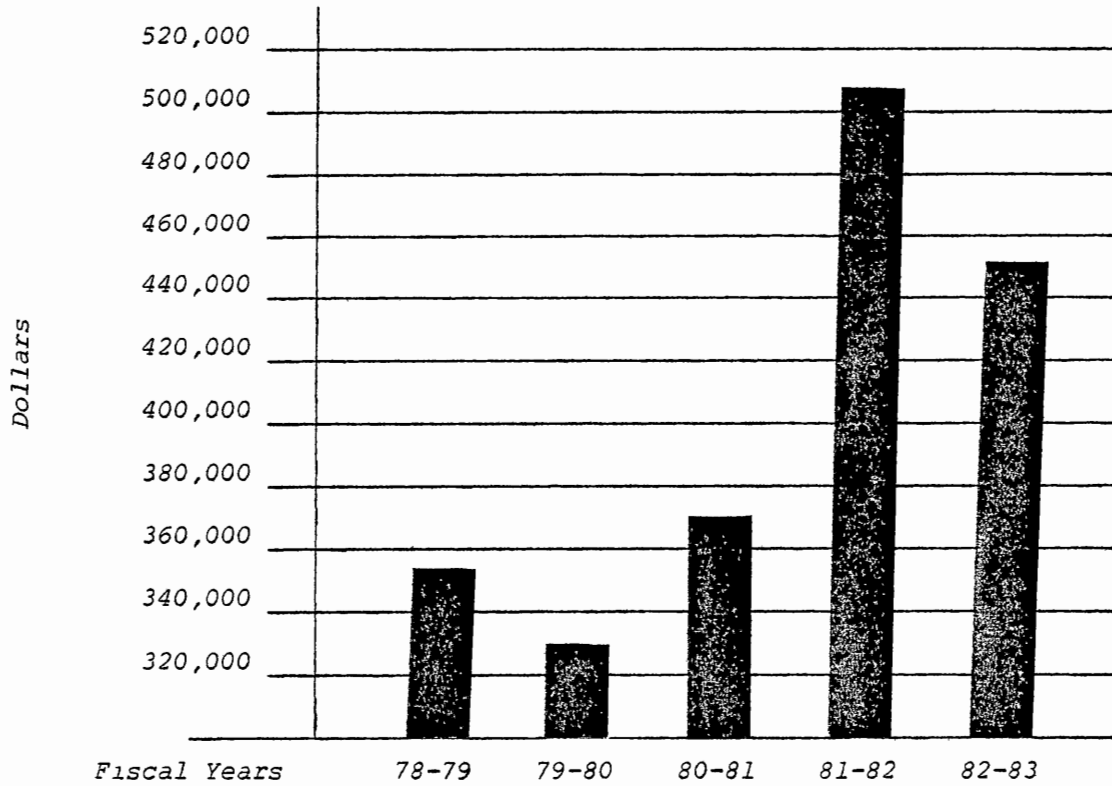

Percentage of change over past Fiscal Year -10%

CAPITAL EXPENDITURES - 1983

Prison, Trenton	\$ 11,712.43	
Prison, Rahway	111.86	
Prison, Leesburg	43,702.67	
YCI-Bordentown	1,304.09	
YRCC-Yardville	16,340.12	
Central Office	4,970.40	
Central Warehouse	12,454.34	
Central Trucking	-0-	+ ordered \$44,698.00
Central Warehouse Print	<u>91,426.20</u>	
	\$182,022.11	<u>\$44,698.00</u>
GRAND TOTAL	\$226,720.11	

To be added to total Machinery & Equipment asset as of 7/1/82 of \$1,811,966.53.

PLANS FOR FUTURE INDUSTRY DEVELOPMENT

The Bureau acknowledges the potential for real growth in the industrial operation through enlargement of its current programs and by the development of new industries. It will be essential to do both to meet the demand of our own Department of Corrections as well as reversing the downward sales trends in the other market areas. Consideration should be given by the Department to allow this Bureau to contribute programs in the newly established institutions, namely Mid-State, Southern, Camden and Newark. Programs for these institutions are available depending upon availability of floor space and number of inmates classified for work.

PRISON, TRENTON

Clothing Shop Replacement and upgrading of sewing equipment

Knit Shop Purchase of additional Automatic Circular Knitting Machines.

Mattress Shop Replacement of sewing equipment.

Machine Shop Dismantling entire shop to provide room for new industry

Development of this 4,000 sq. ft. area for the production of validation stickers to accommodate a new program for the Division of Motor Vehicles pending their implementation and approval.

Print Shop Phasing out of letterpress printing operations and furthering development of offset printing to coincide with staff recruitment.

PLANS FOR FUTURE INDUSTRY DEVELOPMENT (continued)

Pending the implementation of all future industry plans for the State Prison, Trenton, inmate job opportunities could increase from 120 to ..... 161

Total Capital Outlay . . . . . \$320,000.00

STATE PRISON, RAHWAY

Plans have been developed for the occupation of the building vacated by the Regional Laundry in the State Prison, Rahway. This opportunity will allow our Bureau to --

- A. Enlarge our current industrial operation.
- B. Start up a new industry.
- C. Employ more inmates.
- D Provide for better management over the entire operation.

The first floor of the building will consolidate the following shops

Miscellaneous Manufacturing - shop will be expanded to include fabrication of desks, credenzas, and other furniture for office use.

Machine and Bed - shop will be expanded to include its own spray painting operation.

Sign - shop to be upgraded for better efficiency, quality and production

Freight Docks and Industrial Office

The second floor of the building will house an expanded and upgraded Clothing Shop capable of manufacturing garments and gloves in addition to maintaining its present product line

The Basement will provide storage for the production shops This area will be controlled by an expanded storeroom operation.

The Building vacated by the Sign Shop will house a truck Tire Recapping Industry.

Tentative shop plans for both floors of the Laundry Building and the Tire Industry are attached. These shops will be relocated as soon as their designated areas are fully functional

Pending implementation of the above, the number of inmate job opportunities could increase from 94 to . . . . . 256

Total Capital Outlay . . . . . \$320,000.00

PLANS FOR FUTURE INDUSTRY DEVELOPMENT (continued)

STATE PRISON, LEESBURG

Auto Tags Expansion to a reflectorized license plate program is still awaiting implementation of the Law by the Division of Motor Vehicles.

Clothing Further development of Pants and Jacket lines.

Pending implementation of above, the number of inmate job opportunities could increase from 120 to . . . . . .. 135

Total Capital Outlay . . . . . \$65,000.00

YCI-BORDENTOWN

Metal Shop Plans for expanding the product line to include wall lockers and metal office furniture are still dependent upon the availability of floor space and inmates.

Soap Shop Plans for expansion have been shelved due to reduction of floor space and lack of commitment by the institution to maintain the facility.

YRCC-YARDVILLE

Miscellaneous Manufacturing Purchase of another semi-automatic brush making machine.

Mop Shop. Expansion of product line to include dry mops.

Pending implementation of above, inmate job opportunities could increase from 15 to . . . . . 25

Total Capital Outlay . . . . . \$35,000 00

CIW-CLINTON

Clothing Redevelopment of shirt line and expansion of other products.

Pending implementation of the above, inmate job opportunities could increase from 55 to . . . . . 65

Total Capital Outlay . . . . . \$35,000 00

PLANS FOR FUTURE INDUSTRY DEVELOPMENT (continued)

111 OAK STREET

Central Trucking: Replacement of one 10-ton truck.

Central Warehouse Purchase of additional material handling equipment to increase the stocking program of our finished products from 70% up to 85%.

Demolition/Renovation of the Boiler Building to provide additional storage space for our truck fleet and secure area for salvage operations.

Central Warehouse Printing Upgrading of offset duplicating presses.

Pending implementation of above, inmate job opportunities could increase from 15 to . . . . . 32  
Total Capital Outlay . . . \$105,000.00

YCI-ANNANDALE

Proposed The institution unveiled plans to build a 15,000 sq. ft. Industrial Building on the site of the old cannery operation. Accordingly, this Bureau has developed tentative plans to utilize the space to house a state-of-the-art soap operation capable of making hard mill face soap bars and a bulk liquid dispensing operation for the packaging of maintenance and laundry products.  
Additional seasonal industries such as a Snow Fence operation, Pallet Reconditioning and Screen production are under consideration.

Pending implementation of the above, inmate job opportunities could be made available for . . . . . 62  
Total Capital Outlay .. . . . \$150,000.00

INDUSTRIAL EXPANSION RECAP

<u>Industry</u>	<u>Current No. of Inmate Jobs</u>	<u>No of Additional Inmate Jobs "Expansion"</u>	<u>Total No. of Inmate Jobs</u>	<u>Capital Outlay</u>
<u>SP-TRENTON</u>				
Clothing	60	5	65	\$ 15,000.00
Knit	15	2	17	30,000.00
Mattress	10	2	12	5,000 00
Print	30	5	35	80,000 00
Proposed Print	--	25	25	175,000.00
Storage	5	2	7	15,000.00
	<u>120</u>	<u>41</u>	<u>161</u>	<u>\$ 320,000.00</u>
<u>SP-RAHWAY</u>				
Clothing	40	60	100	\$ 100,000.00
Machine/Bed	12	26	38	30,000.00
Miscellaneous	12	26	38	25,000.00
Sign	20	20	40	15,000.00
Storeroom/Office	10	5	15	---
Tire	--	25	25	150,000.00
	<u>94</u>	<u>162</u>	<u>256</u>	<u>\$ 320,000.00</u>
<u>YCI-BORDENTOWN</u>				
Metal	55	--	55	\$ ---
Soap	25	--	25	---
	<u>80</u>	<u>--</u>	<u>80</u>	<u>\$ ---</u>
<u>SP-LEESBURG</u>				
Auto Tag	30	5	35	\$ 50,000.00
Clothing	90	10	100	15,000.00
	<u>120</u>	<u>15</u>	<u>135</u>	<u>\$ 65,000 00</u>
<u>CIW-CLINTON</u>				
Clothing	55	10	65	\$ 35,000.00
<u>YRCC-YARDVILLE</u>				
Miscellaneous	12	7	19	\$ 25,000 00
Mop	3	3	6	10,000.00
	<u>15</u>	<u>10</u>	<u>25</u>	<u>\$ 35,000 00</u>
<u>111 OAK ST</u>				
Trucking	--	--	--	\$ 35,000.00
Warehouse	12	15	27	50,000 00
Print	3	2	5	20,000.00
	<u>15</u>	<u>17</u>	<u>32</u>	<u>\$ 105,000 00</u>
<u>YCI-ANNANDALE</u>				
Proposed	--	62	62	\$ 150,000 00
<u>GRAND TOTALS</u>	<u>499</u>	<u>317</u>	<u>816</u>	<u>\$1,030,000.00</u>

RAHWAY LAUNDRY BLDG.  
1st Floor

- (1) Sign Shop
- (2) Machine & Bed
- (3) Miscellaneous Mfg.

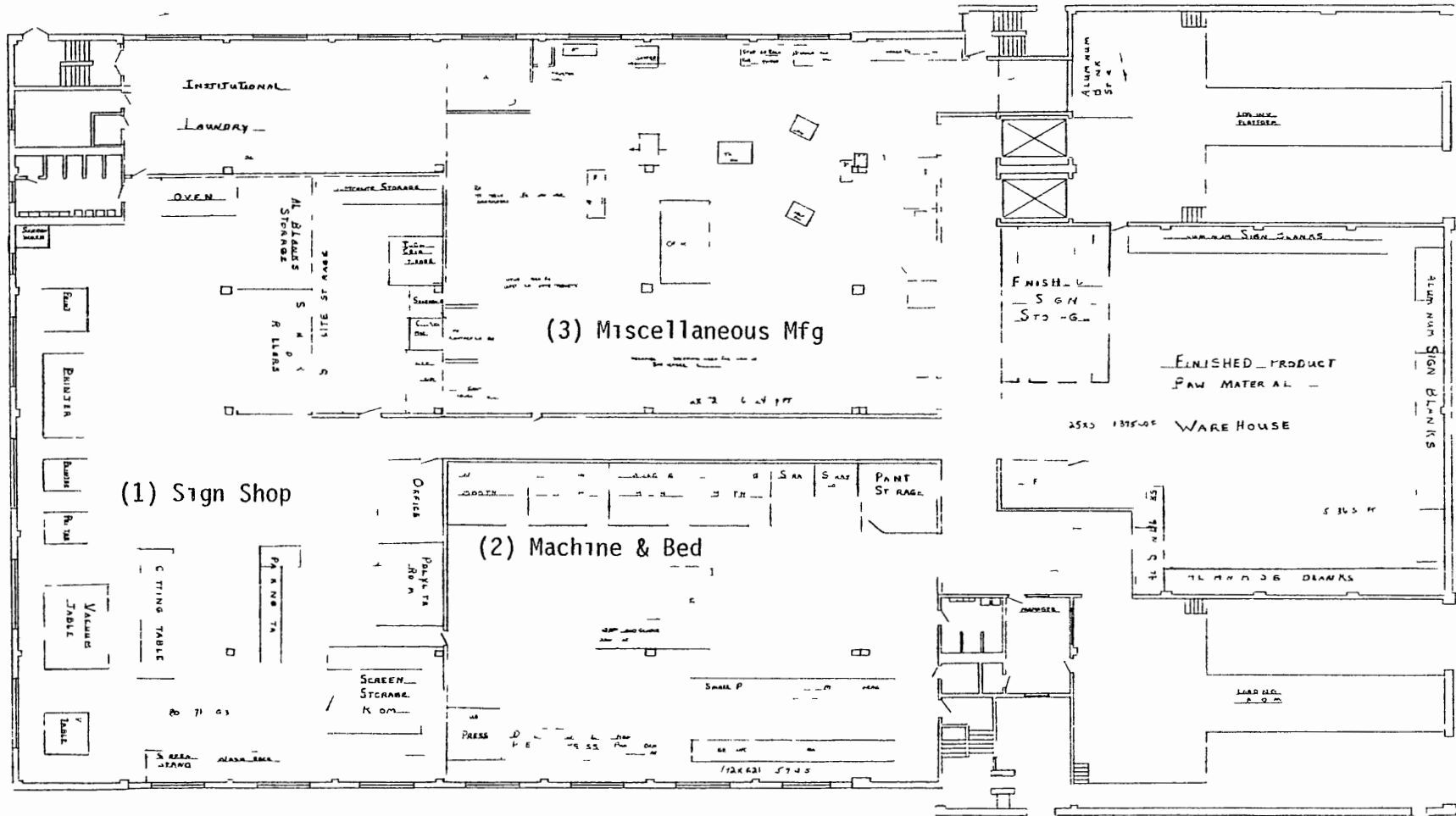

RAHWAY LAUNDRY BLDG TOP FLOOR  
1,500 sq ft

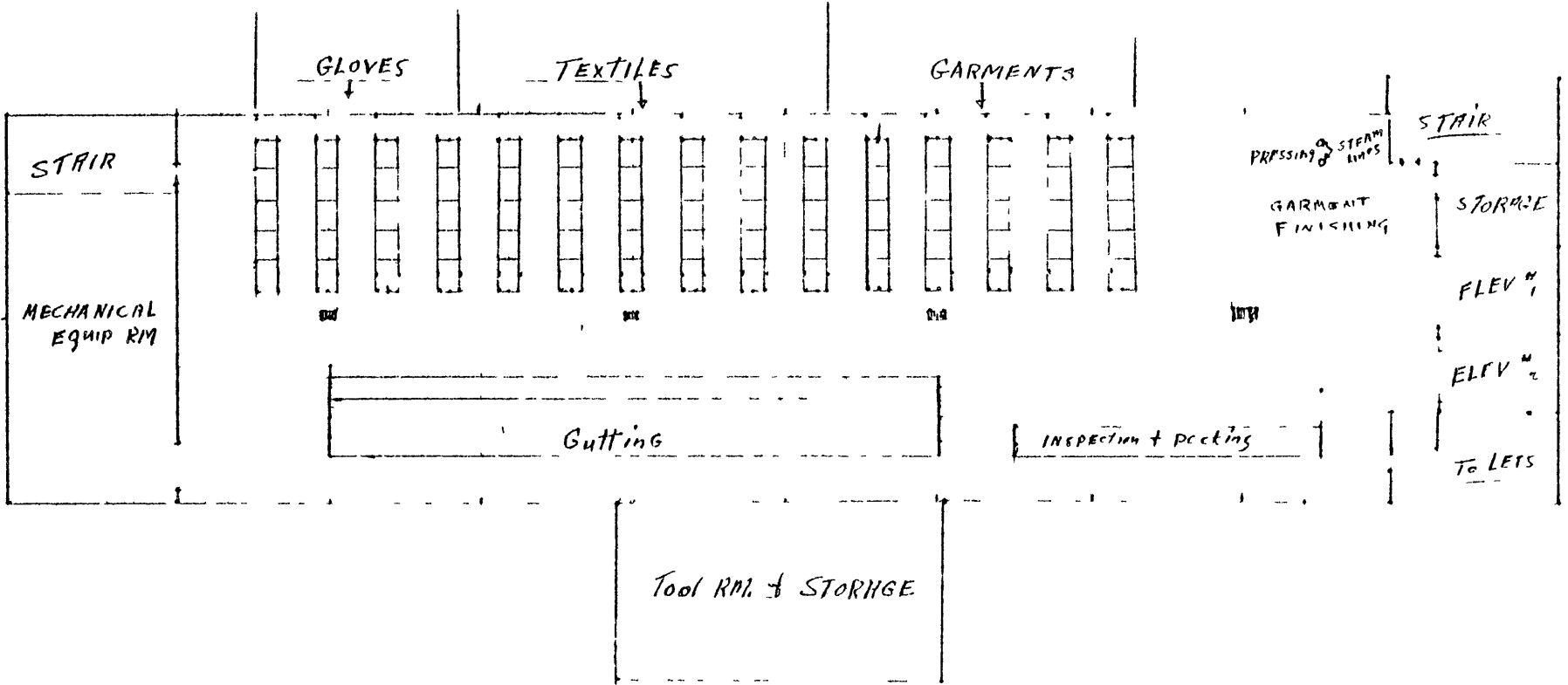

Typical Layout

(3) Truck Tire Recapping

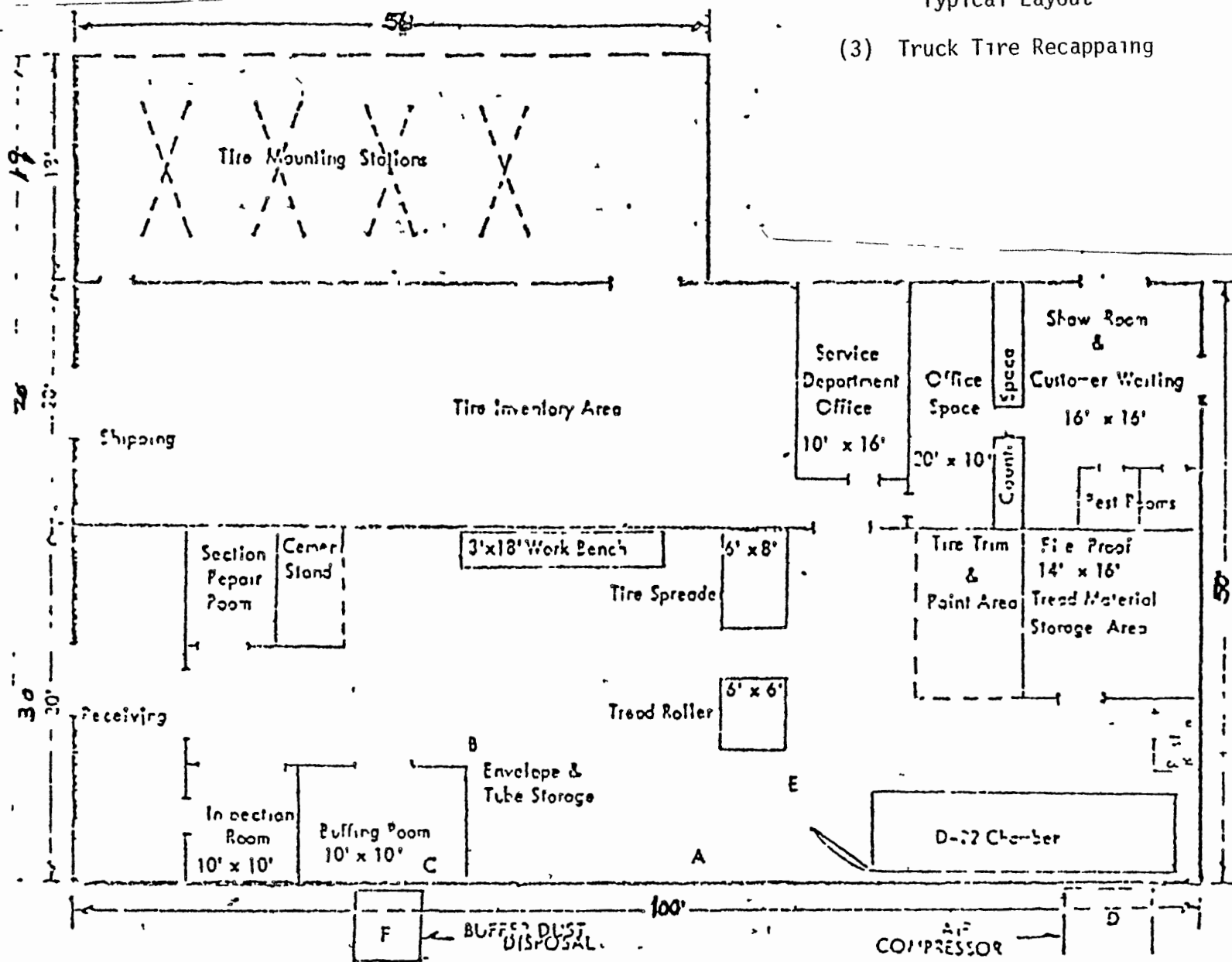

Proposed Industrial Building

YCI-ANNANDALE

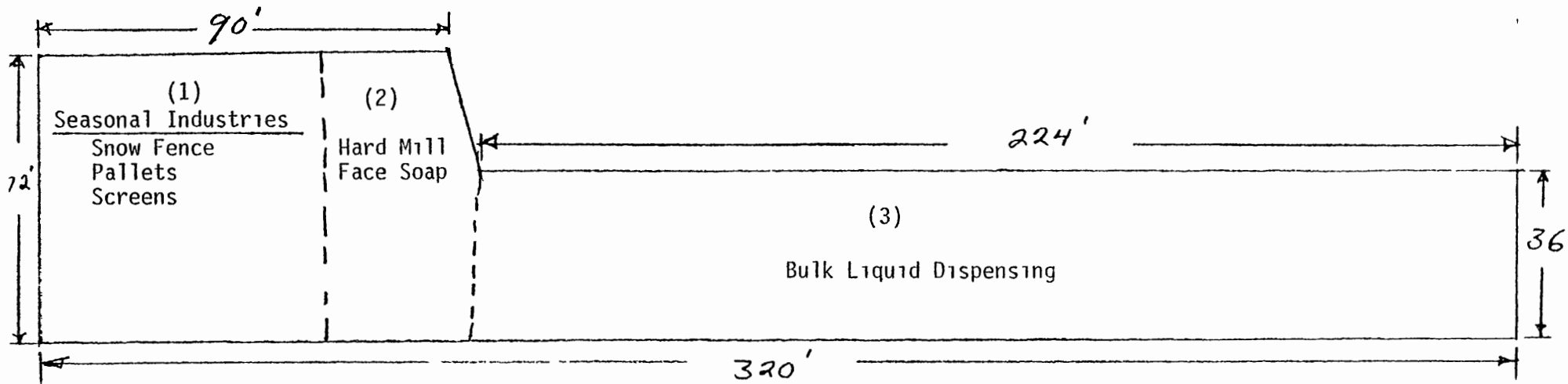

## CONCLUSION

This Annual Report has attempted to provide the reader with an overview of the accomplishments the Bureau made during the past year. In addition we have spent a great deal of time and effort in developing plans for the future expansions of its industries. These plans as stated will serve as a guideline for the Bureau's future growth.

State Use looks forward with enthusiasm to the challenges it will face in the next fiscal year.